

I HEREBY CERTIFY, that the precise address of the Grantee herein is

Mr. Edward E. Clark
RD 5, Box 561
Bedford, PA 15522

Edith A. Clark
Atty. for Grantor

NTS

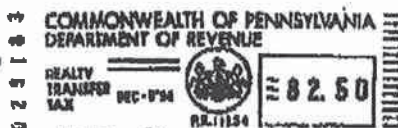

REALTY TRANSFER TAX
NAPIER TOWNSHIP
PAID: \$41.25
DATE: DECEMBER 9, 1994
Faith A. Zembower
FAITH A. ZEMBOWER, RECORDER

REALTY TRANSFER TAX
CHESTNUT RIDGE SCHOOL DISTRICT
PAID: \$41.25
DATE: DECEMBER 9, 1994
Faith A. Zembower
FAITH A. ZEMBOWER, RECORDER

COMMONWEALTH OF PENNSYLVANIA {S.S.
COUNTY OF BEDFORD
RECORDED in the office for recording of deeds in and
to said county in Book 1 575
200 566
Witness my hand and seal of office at Bedford,
Pennsylvania this 9th
day of December A.D. 1994
Faith A. Zembower

RECORDED
DEC -9 1994
Faith A. Zembower
REC'D
\$ 14.00



**LIBERTY
TOWERS**

Liberty Towers, LLC

Site Candidate Information Package (SCIP)

Submittal Date: 24-Jun-08

Liberty Site #: NA

Market: PA

Search Ring Name: Schellsburg

Search Ring #: NA

Candidate Name: Clark

Candidate Letter: B

Acquisition Firm: Faulk and Foster

Site Acq Agent: David A. Newton

Phone Number: 616-975-0923 ex 112

Checklist & Enclosures

Attach to the back of the SCIP package.

- ☒ Street Map with site marked
- ☒ Topographical map with site marked (must show elevations - note contour interval)
- ☒ Tax map with site marked
- ☐ Zoning Map with site marked
- ☐ Existing Survey/Plat of property ☒ Not available
- ☒ Copy of most recent tax bill or property appraiser print-out
- ☒ Photographs of site area (from North, South, East, and West)
- ☒ Photographs of access road (from main road to site area & from site area back to main road)
- ☒ Photographs of existing TELCO facilities
- ☒ Photographs of existing power company facilities
- ☒ Vicinity Map
- ☐ Other
- ☐ Other
- ☐ Other

Site Owner Information

Landlord Information

Landlord: John A. Clark, et al

Company: _____

Address 1: 7391 Lincoln Highway

Address 2: _____

City, State, Zip: Bedford, PA 15522

Phone: 814-623-8058

Fax: NA

Email: NA

Tax ID: To be provided

Contact/Site Mgr Info

Contact: Same As above

Company: _____

Address 1: _____

Address 2: _____

City, State, Zip: _____

Phone: _____

Fax: _____

Email: _____



**LIBERTY
TOWERS**

Liberty Towers, LLC

Site Candidate Information Package (SCIP)

Site Location/Information

Latitude: N40 03 02.4 Longitude: W 78 39 34.5 Nad 27: _____
Ground Elevation (ft): 1525' Nad 83: x
Proposed Type: Self Support Proposed Height (ft): 230'
Address: Approximately 200 W. Ridge Road
City, State, Zip: Schellsburg, PA 15559
County: Bedford
Tax ID: C08 0 00 082
Is this the 911 Address? _____ Yes x No

IF THIS SITE DOES NOT HAVE A STREET ADDRESS, PLEASE COMPLETE THE FOLLOWING:

Nearest Property:

Address: John Rose, 336 W. Ridge Road
City, State, Zip: Schellsburg, PA 15559

Distance & Direction to site: approximately 600' to south west along W. Ridge Road
Nearest Cross Street: .5 miles to south west, W. Ridge Road and US 30
Lease area dimensions: 100'x100'
Size of entire tract: 90 Acres
Existing use: Forest land

Driving Directions:

From Washington DC: I-495 North to I-270. Proceed north on I-270 to I-70. Continue North on I70 to Penn. Turnpike. Proceed West on Penn Turnpike to Exit 146. Proceed West on US 30 approximately 7 miles to West Ridge Road, Turn right (northeast) and proceed approximately .5 miles. Site is on the right in wooded area. Site and entrance are staked.



**LIBERTY
TOWERS**

Liberty Towers, LLC

Site Candidate Information Package (SCIP)

Business Terms Proposal

Proposed Rental Rate: \$500
Initial term (yrs): Standard Lease terms
Payment basis: Monthly
Number of renewal terms: Standard Lease terms
Escalation: 3% annual
Renewal Duration (yrs): Standard Lease terms

Additional Negotiation Points:

Standard lease agreement given to landlord. Word is out that the general monthly rent for tower site is \$500 per month for 100'x100' site. Landlord agrees to terms. Site staked. LL owns much of the land in the search. They do not want to "waste" the plowed fields on a tower and they feel that the tower is better positioned in the treed portion of their property for screening. With some coaxing, agent believes they will place the tower in a corner of an open field. There are five brothers that own the property. All were polled and all expressed willingness to lease.

Zoning Information

Jurisdiction 1 Napier Township, Bedford County, PA
Address 1: 1708 Market Street
Address 2: _____
City, State, Zip: Schellsburg, PA
Contact: Judy Kendall
Title: Township Secretary
Phone: 814-733-4770
Fax: _____
Email: None

Jurisdiction 2 NA
Address 1: _____
Address 2: _____
City, State, Zip: _____
Contact: _____
Title: _____
Phone: _____
Fax: _____
Email: _____

Current Zoning Classification: Agricultural Use - No Zoning
Overlay District: None



Liberty Towers, LLC

Site Candidate Information Package (SCIP)

Utilities

Existing power at site: ☐ Yes ☒ No
Power Company: Bedford Rural Electric Cooperative
Power Co Contact Name/Phone: Customer Support Representative (814) 623-5101
Approximate distance to site: approximately 600' to northeast at Rose residence
Pole number: F-205-4

Existing TELCO at site: ☐ Yes ☒ No
Telephone Company: EMBARQ
TELCO Contact Name/Phone: Business Support Representative (888)-723-8010
Approximate distance to site: 600' to the northeast at Rose residence

Site Access

Access easement required?: ☐ Yes ☒ No
From third party?: ☐ Yes ☒ No
Access from public road: ☒ Yes ☐ No
Special access (4wd, etc): No
Needed improvements to access: ☒ Yes ☐ No
Existing road: ☐ Yes ☒ No

Width & length of existing road: 12"x200' two track
Width & length of proposed road: 20"x200' gravel road
Separate utility easement req'd?: ☐ Yes ☒ No
From third party?: ☐ Yes ☒ No
Access restrictions: None.
Crane accessible?: ☒ Yes ☐ No
Construction equip restrictions: ☐ Yes ☐ No
Site accessible 24/7?: ☒ Yes ☐ No

AREA MAP

DELORME

Street Atlas USA® 2008 Plus

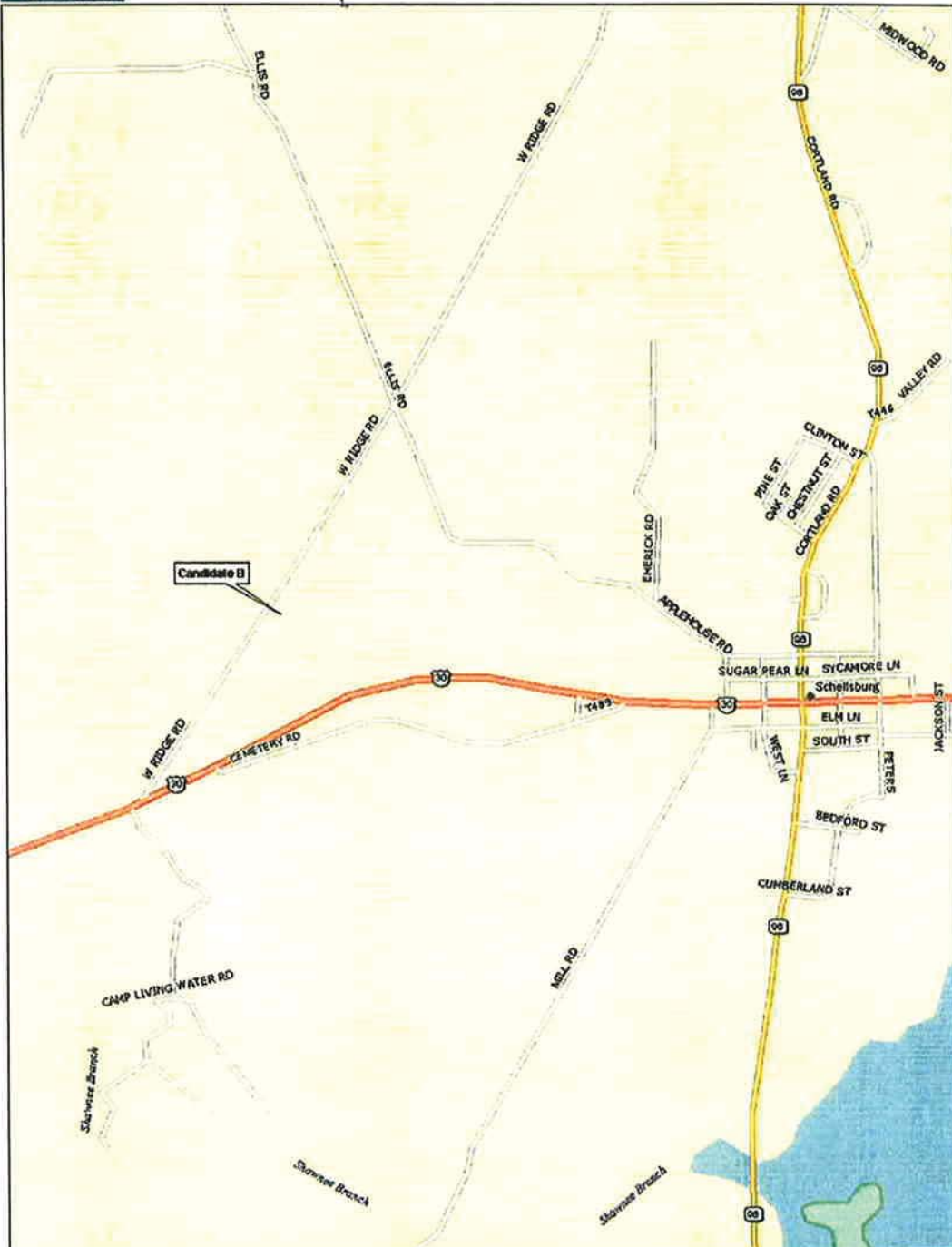

Data use subject to license.

© 2007 DeLorme. Street Atlas USA® 2008 Plus.

www.delorme.com

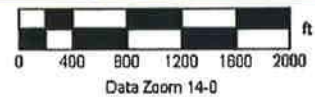

AERIAL MAP



TOPO MAP

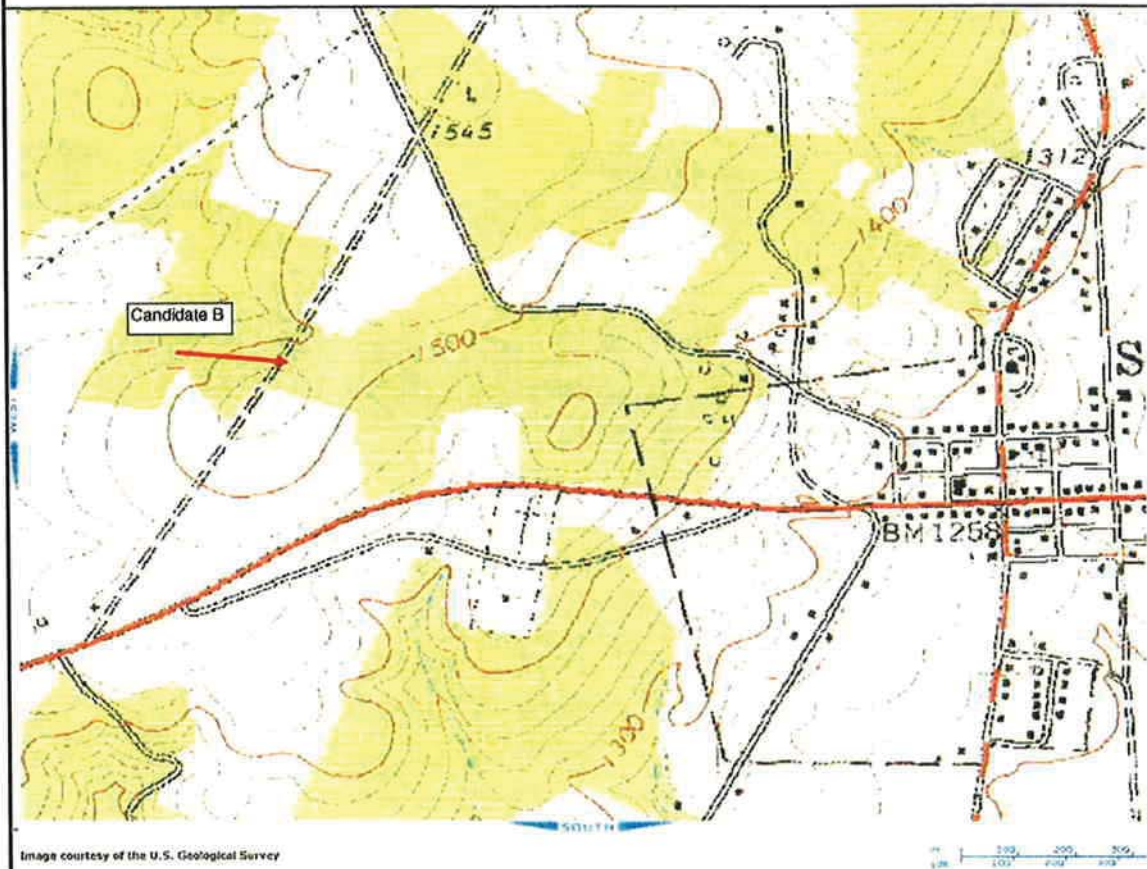

Image courtesy of the U.S. Geological Survey

TAX DATA

REL426D

COUNTY OF BEDFORD, PENNSYLVANIA
Public Inquiry

Cntl Number 220 14820
Map Number C. 08-0.00-082
Old Ref

Acreage 90.000
NAPIER TOWNSHIP
CHESTNUT RIDGE S D

Grantor CLARK JOHN A 1/6 INT
Grantee(1) CLARK EDWARD E ETAL
(2)
Address 7391 LINCOLN HWY
BEDFORD PA 15522

Land Use Code A
Consideration
Sale Date 12/01/1994
Deed Bk/Pg 0575 0366
Taxable/Exmpt TAXABLE
Clean&Green?

SITUS: Desc. (1)
(2)
Property Desc. (1)
(2)
(3)

Preferred Land Val
Land Val
Improvement Val
Mineral Val

2491

Tot Val:

2491

F10=Sales

F12=Cancel

F5=Tax

[illegible]

ZONING MAP

No Zoning in Napier Township - No zoning map available.

1.

Candidate B - photos

Facing north - view of the tower site



Facing south - view of the tower site



Candidate B - photos

Facing west - view of the tower site



Facing east - view of the tower site



Candidate B - photos

Facing east - view of proposed access

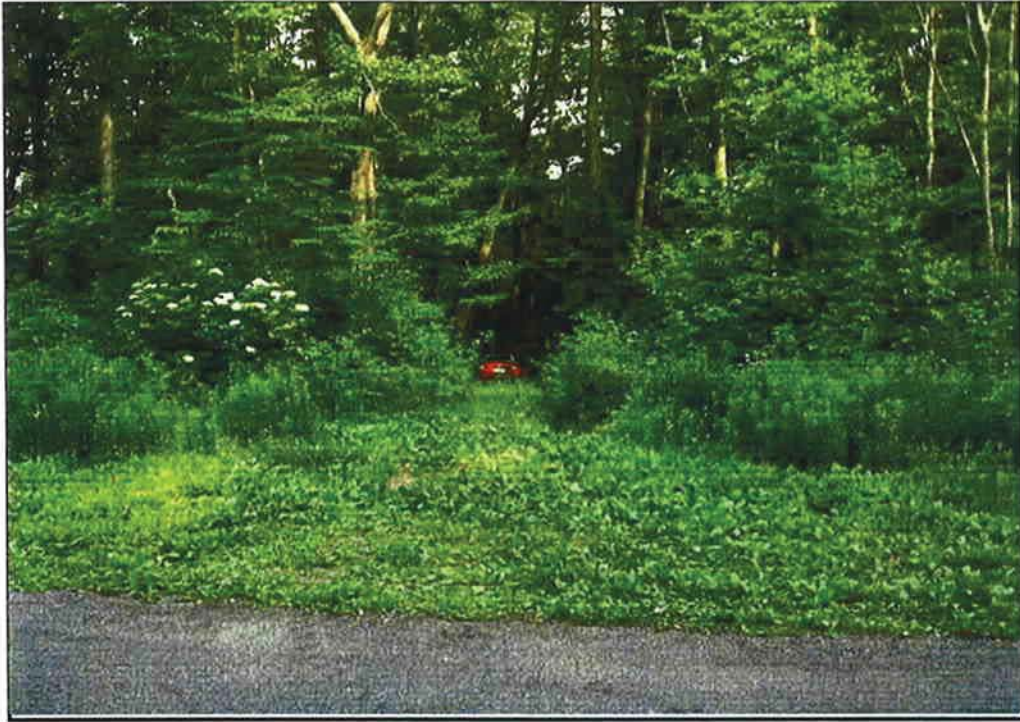

Facing northeast - view of power pole

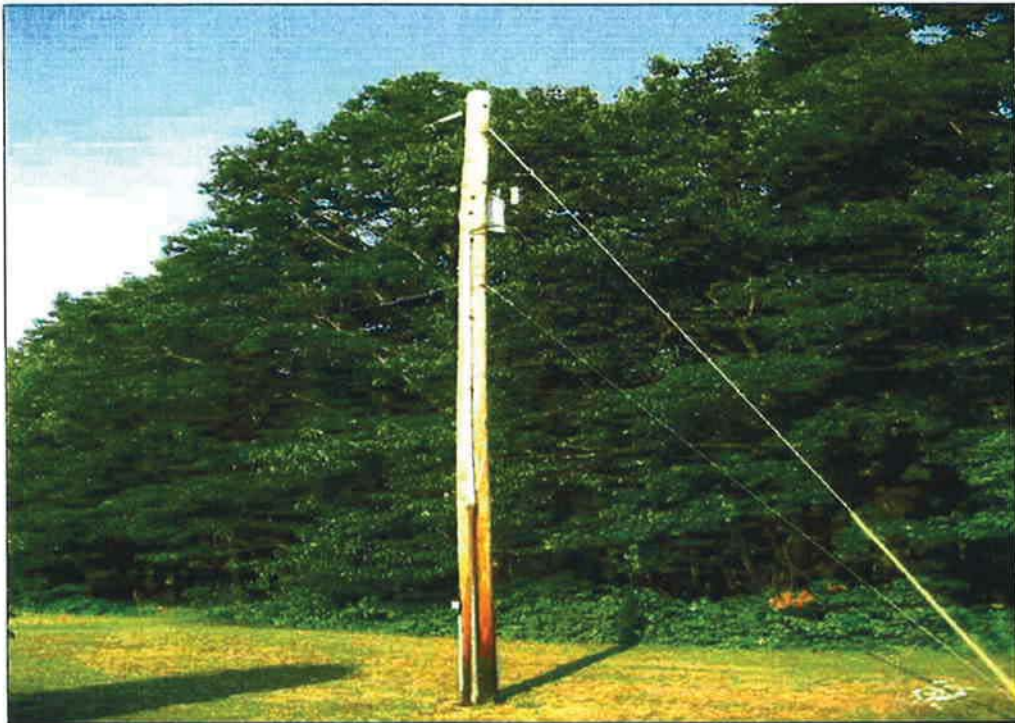

Candidate B - photos

Facing north on W. Ridge Rd. Site on right



Facing south on W. Ridge Road. Site on left



Vicinity Map

DeLORME

Street Atlas USA® 2008 Plus

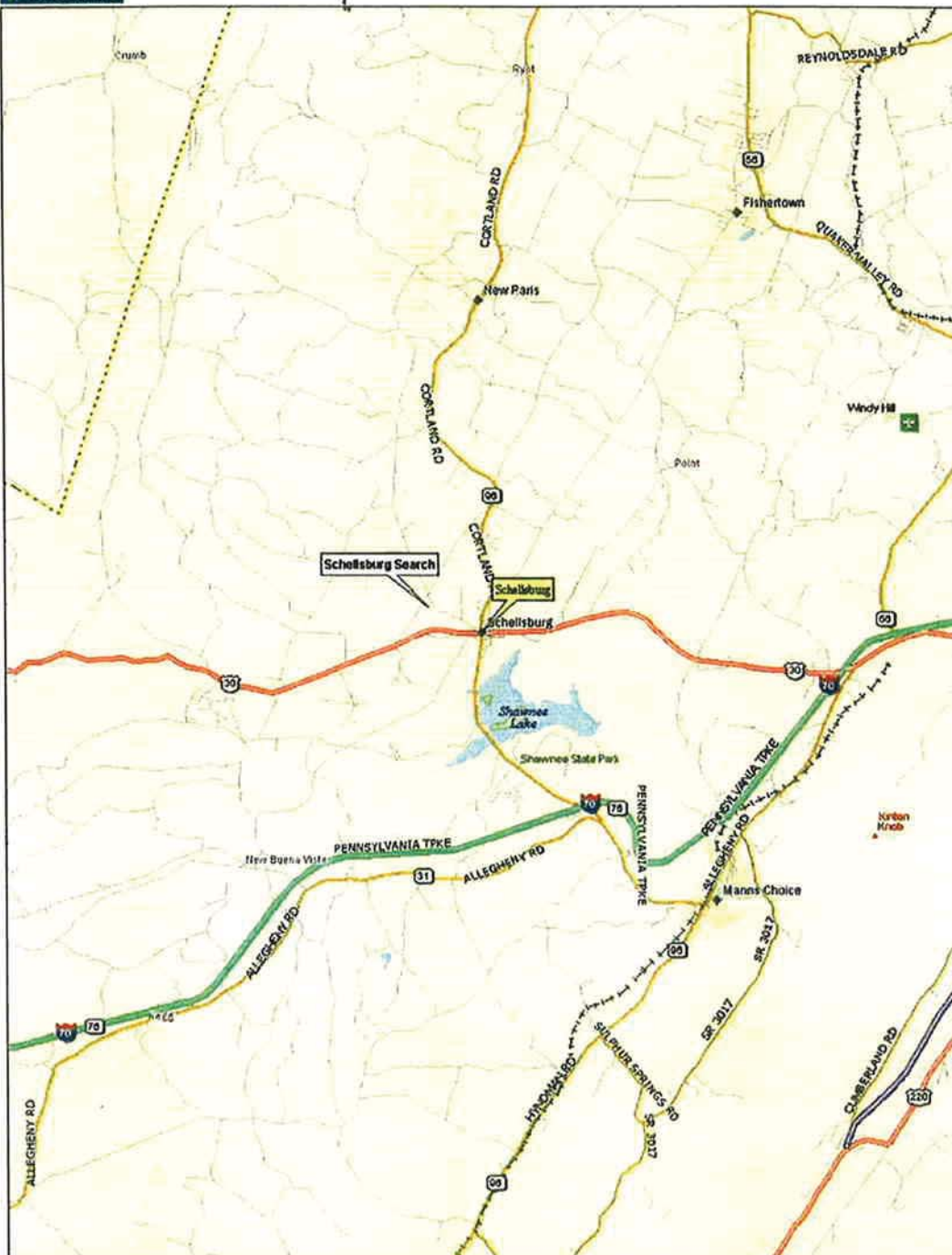

Data use subject to license

© 2007 DeLorme Street Atlas USA® 2008 Plus.

www.delorme.com

MN (9.8° W)

0 1/2 1 1 1/2 2 2 1/2
Data Zoom 11-0

ELIMINATION MAP

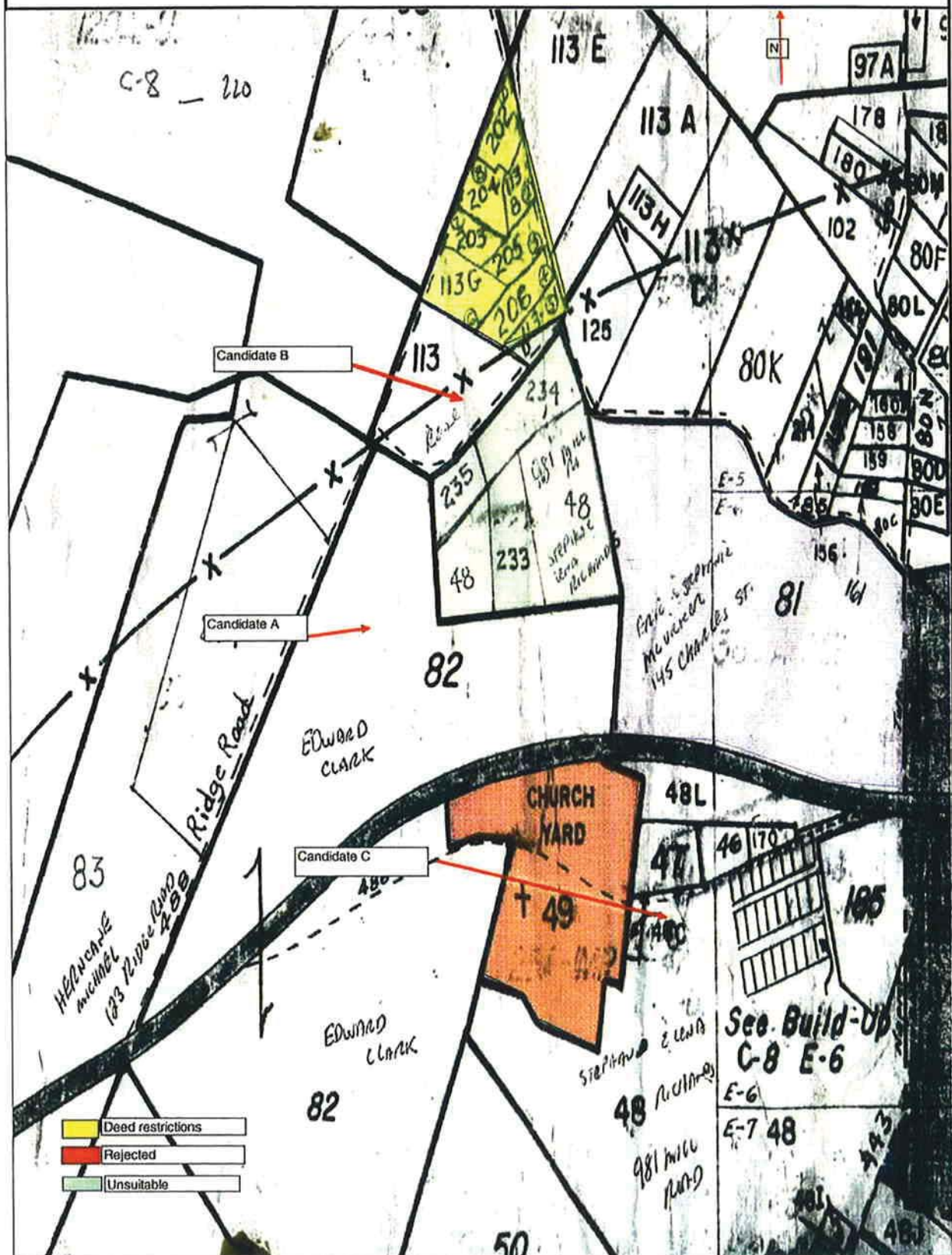

07/03/2008 12:50 814-733-2033

NAPIER TOWNSHIP

PAGE 02



Napier Township
Attn: Judy Kendall
1708 Market St.
Schellsburg, MI

Today I contacted you regarding telecommunications zoning for Napier Township. At that time you informed me that Napier Township requires no zoning approval. In order to confirm that my understanding of the matter is correct, please sign below and fax this letter back to my office.

Thomas Forshee, Zoning Specialist

W. E. B. D. Sec. - TREAS.

NAPIER TWP HAS NO ZONING ORDINANCE.

8440 Charlevoix Drive SE, Suite 202, Grand Rapids, MI 49546
616.975.0925, Fax 616.975.0920
fontkondfoster.com

fontendfoster.com

2002/002

Faulk & Foster

07/03/2008 11:53 FAX 8188750920

APPENDIX C
DATABASE SEARCH

Schellsburg Liberty Towers Site

200 West Ridge Road
Schellsburg, PA 15559

Inquiry Number: 2420965.2s
February 13, 2009

The EDR Radius Map™ Report with GeoCheck®

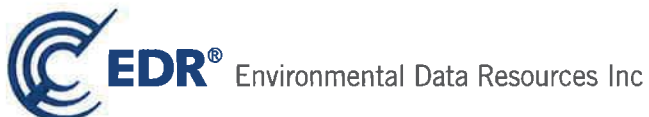

440 Wheelers Farms Road
Milford, CT 06461
Toll Free: 800.352.0050
www.edrnet.com

TABLE OF CONTENTS

<u>SECTION</u>	<u>PAGE</u>
Executive Summary	ES1
Overview Map	2
Detail Map	3
Map Findings Summary	4
Map Findings	7
Orphan Summary	8
Government Records Searched/Data Currency Tracking	GR-1
 <u>GEOCHECK ADDENDUM</u>	
Physical Setting Source Addendum	A-1
Physical Setting Source Summary	A-2
Physical Setting SSURGO Soil Map	A-5
Physical Setting Source Map	A-12
Physical Setting Source Map Findings	A-13
Physical Setting Source Records Searched	A-69

Thank you for your business.
Please contact EDR at 1-800-352-0050
with any questions or comments.

Disclaimer - Copyright and Trademark Notice

This Report contains certain information obtained from a variety of public and other sources reasonably available to Environmental Data Resources, Inc. It cannot be concluded from this Report that coverage information for the target and surrounding properties does not exist from other sources. **NO WARRANTY EXPRESSED OR IMPLIED, IS MADE WHATSOEVER IN CONNECTION WITH THIS REPORT. ENVIRONMENTAL DATA RESOURCES, INC. SPECIFICALLY DISCLAIMS THE MAKING OF ANY SUCH WARRANTIES, INCLUDING WITHOUT LIMITATION, MERCHANTABILITY OR FITNESS FOR A PARTICULAR USE OR PURPOSE. ALL RISK IS ASSUMED BY THE USER. IN NO EVENT SHALL ENVIRONMENTAL DATA RESOURCES, INC. BE LIABLE TO ANYONE, WHETHER ARISING OUT OF ERRORS OR OMISSIONS, NEGLIGENCE, ACCIDENT OR ANY OTHER CAUSE, FOR ANY LOSS OF DAMAGE, INCLUDING, WITHOUT LIMITATION, SPECIAL, INCIDENTAL, CONSEQUENTIAL, OR EXEMPLARY DAMAGES. ANY LIABILITY ON THE PART OF ENVIRONMENTAL DATA RESOURCES, INC. IS STRICTLY LIMITED TO A REFUND OF THE AMOUNT PAID FOR THIS REPORT.** Purchaser accepts this Report "AS IS". Any analyses, estimates, ratings, environmental risk levels or risk codes provided in this Report are provided for illustrative purposes only, and are not intended to provide, nor should they be interpreted as providing any facts regarding, or prediction or forecast of, any environmental risk for any property. Only a Phase I Environmental Site Assessment performed by an environmental professional can provide information regarding the environmental risk for any property. Additionally, the information provided in this Report is not to be construed as legal advice.

Copyright 2009 by Environmental Data Resources, Inc. All rights reserved. Reproduction in any media or format, in whole or in part, of any report or map of Environmental Data Resources, Inc., or its affiliates, is prohibited without prior written permission.

EDR and its logos (including Sanborn and Sanborn Map) are trademarks of Environmental Data Resources, Inc. or its affiliates. All other trademarks used herein are the property of their respective owners.

EXECUTIVE SUMMARY

A search of available environmental records was conducted by Environmental Data Resources, Inc (EDR). The report was designed to assist parties seeking to meet the search requirements of EPA's Standards and Practices for All Appropriate Inquiries (40 CFR Part 312), the ASTM Standard Practice for Environmental Site Assessments (E 1527-05) or custom requirements developed for the evaluation of environmental risk associated with a parcel of real estate.

TARGET PROPERTY INFORMATION

ADDRESS

200 WEST RIDGE ROAD
SCHELLSBURG, PA 15559

COORDINATES

Latitude (North):	40.051700 - 40° 3' 6.1"
Longitude (West):	78.658200 - 78° 39' 29.5"
Universal Transverse Mercator:	Zone 17
UTM X (Meters):	699759.4
UTM Y (Meters):	4435913.0
Elevation:	1508 ft. above sea level

USGS TOPOGRAPHIC MAP ASSOCIATED WITH TARGET PROPERTY

Target Property Map:	40078-A6 SCHELLSBURG, PA
Most Recent Revision:	1984

AERIAL PHOTOGRAPHY IN THIS REPORT

Photo Year:	2005
-------------	------

TARGET PROPERTY SEARCH RESULTS

The target property was not listed in any of the databases searched by EDR.

DATABASES WITH NO MAPPED SITES

No mapped sites were found in EDR's search of available ("reasonably ascertainable ") government records either on the target property or within the search radius around the target property for the following databases:

STANDARD ENVIRONMENTAL RECORDS

Federal NPL site list

NPL.....	National Priority List
Proposed NPL.....	Proposed National Priority List Sites

EXECUTIVE SUMMARY

NPL LIENS..... Federal Superfund Liens

Federal Delisted NPL site list

Delisted NPL..... National Priority List Deletions

Federal CERCLIS list

CERCLIS..... Comprehensive Environmental Response, Compensation, and Liability Information System

Federal CERCLIS NFRAP site List

CERC-NFRAP..... CERCLIS No Further Remedial Action Planned

Federal RCRA CORRACTS facilities list

CORRACTS..... Corrective Action Report

Federal RCRA non-CORRACTS TSD facilities list

RCRA-TSDF..... RCRA - Transporters, Storage and Disposal

Federal RCRA generators list

RCRA-LQG..... RCRA - Large Quantity Generators

RCRA-SQG..... RCRA - Small Quantity Generators

RCRA-CESQG..... RCRA - Conditionally Exempt Small Quantity Generator

Federal institutional controls / engineering controls registries

US ENG CONTROLS..... Engineering Controls Sites List

US INST CONTROL..... Sites with Institutional Controls

Federal ERNS list

ERNS..... Emergency Response Notification System

State- and tribal - equivalent NPL

SHWS..... Hazardous Sites Cleanup Act Site List

HSCA..... HSCA Remedial Sites Listing

State and tribal landfill and/or solid waste disposal site lists

SWF/LF..... Operating Facilities

State and tribal leaking storage tank lists

LUST..... Storage Tank Release Sites

UNREG LTANKS..... Unregulated Tank Cases

LAST..... Storage Tank Release Sites

INDIAN LUST..... Leaking Underground Storage Tanks on Indian Land

State and tribal registered storage tank lists

UST..... Listing of Pennsylvania Regulated Underground Storage Tanks

EXECUTIVE SUMMARY

AST..... Listing of Pennsylvania Regulated Aboveground Storage Tanks
INDIAN UST..... Underground Storage Tanks on Indian Land

State and tribal institutional control / engineering control registries

ENG CONTROLS..... Engineering Controls Site Listing
INST CONTROL..... Institutional Controls Site Listing

State and tribal voluntary cleanup sites

INDIAN VCP..... Voluntary Cleanup Priority Listing
VCP..... Voluntary Cleanup Program Sites

State and tribal Brownfields sites

BROWNFIELDS..... Brownfields Sites

ADDITIONAL ENVIRONMENTAL RECORDS

Local Brownfield lists

US BROWNFIELDS..... A Listing of Brownfields Sites

Local Lists of Landfill / Solid Waste Disposal Sites

ODI..... Open Dump Inventory
DEBRIS REGION 9..... Torres Martinez Reservation Illegal Dump Site Locations
HIST LF..... Abandoned Landfill Inventory
INDIAN ODI..... Report on the Status of Open Dumps on Indian Lands

Local Lists of Hazardous waste / Contaminated Sites

US CDL..... Clandestine Drug Labs

Local Lists of Registered Storage Tanks

ARCHIVE UST..... Archived Underground Storage Tank Sites
ARCHIVE AST..... Archived Aboveground Storage Tank Sites

Local Land Records

LIENS 2..... CERCLA Lien Information
LUCIS..... Land Use Control Information System
ACT 2-DEED..... Act 2-Deed Acknowledgment Sites

Records of Emergency Release Reports

HMIRS..... Hazardous Materials Information Reporting System
SPILLS..... State spills

Other Ascertainable Records

RCRA-NonGen..... RCRA - Non Generators
DOT OPS..... Incident and Accident Data

EXECUTIVE SUMMARY

DOD.....	Department of Defense Sites
FUDS.....	Formerly Used Defense Sites
CONSENT.....	Superfund (CERCLA) Consent Decrees
ROD.....	Records Of Decision
UMTRA.....	Uranium Mill Tailings Sites
MINES.....	Mines Master Index File
TRIS.....	Toxic Chemical Release Inventory System
TSCA.....	Toxic Substances Control Act
FTTS.....	FIFRA/ TSCA Tracking System - FIFRA (Federal Insecticide, Fungicide, & Rodenticide Act)/TSCA (Toxic Substances Control Act)
HIST FTTS.....	FIFRA/TSCA Tracking System Administrative Case Listing
SSTS.....	Section 7 Tracking Systems
ICIS.....	Integrated Compliance Information System
PADS.....	PCB Activity Database System
MLTS.....	Material Licensing Tracking System
RADINFO.....	Radiation Information Database
FINDS.....	Facility Index System/Facility Registry System
RAATS.....	RCRA Administrative Action Tracking System
MANIFEST.....	Manifest Information
DRYCLEANERS.....	Drycleaner Facility Locations
AIRS.....	Permit and Emissions Inventory Data
INDIAN RESERV.....	Indian Reservations
SCRD DRYCLEANERS.....	State Coalition for Remediation of Drycleaners Listing
PWS.....	Public Water System Data

EDR PROPRIETARY RECORDS

EDR Proprietary Records

Manufactured Gas Plants..... EDR Proprietary Manufactured Gas Plants

SURROUNDING SITES: SEARCH RESULTS

Surrounding sites were not identified.

Unmappable (orphan) sites are not considered in the foregoing analysis.

EXECUTIVE SUMMARY

Due to poor or inadequate address information, the following sites were not mapped:

Site Name

GILBERT BROS
SCHELLSBURG AMOCO
DAN AND SONS BODY SHOP
SCHELLSBURG VALLEY VOL FIRE DEPT

Database(s)

ARCHIVE UST
RCRA-SQG, FINDS
FINDS, RCRA-CESQG
FINDS

OVERVIEW MAP - 2420965.2s

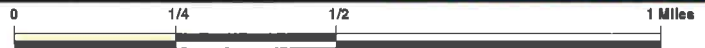
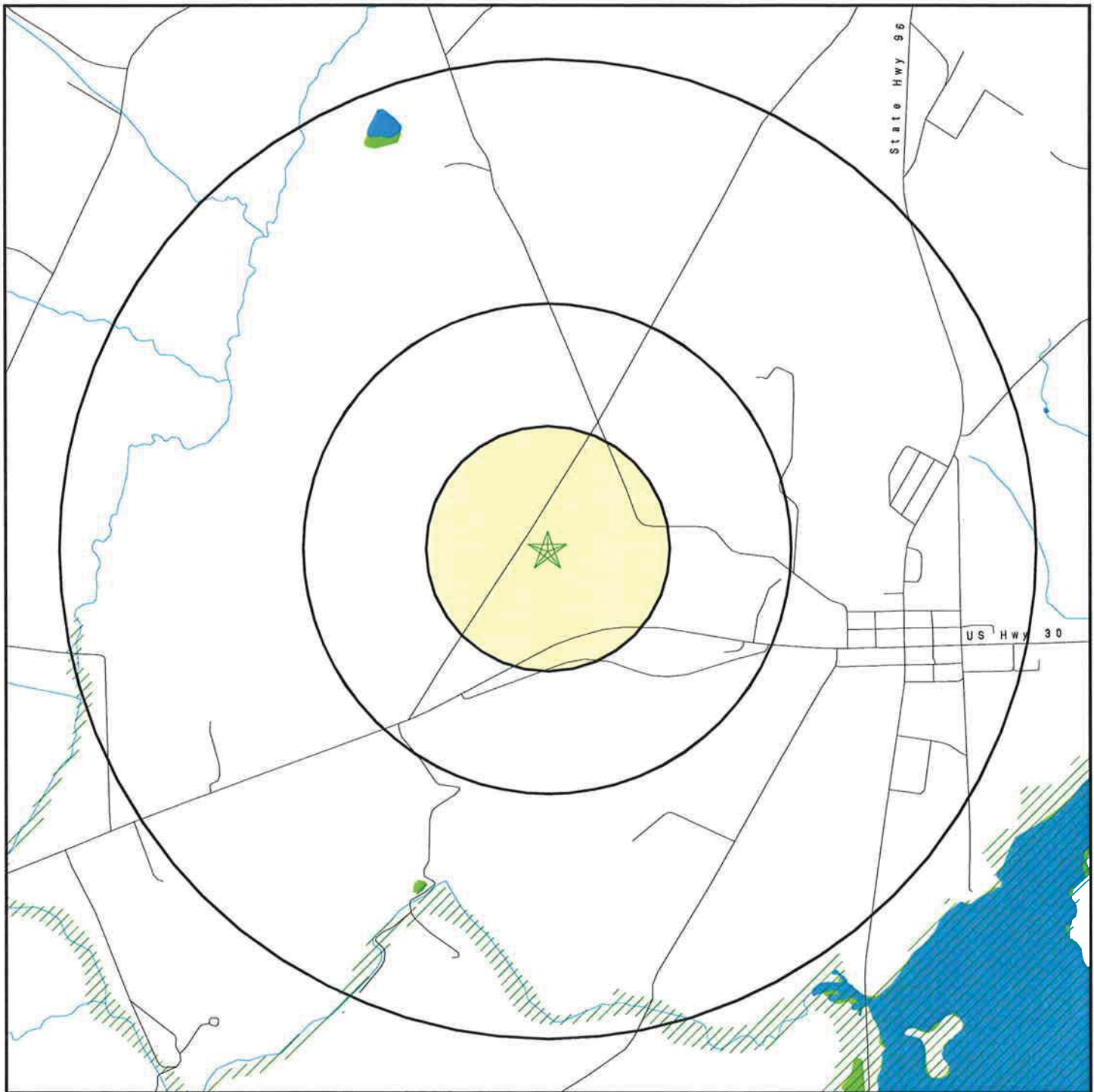

- ★ Target Property
- ▲ Sites at elevations higher than or equal to the target property
- ◆ Sites at elevations lower than the target property
- ▲ Manufactured Gas Plants
- National Priority List Sites
- Dept. Defense Sites
- Indian Reservations BIA
- Oil & Gas pipelines
- 100-year flood zone
- 500-year flood zone
- National Wetland Inventory

This report includes Interactive Map Layers to display and/or hide map information. The legend includes only those icons for the default map view.

SITE NAME: Schellsburg Liberty Towers Site
 ADDRESS: 200 West Ridge Road
 Schellsburg PA 15559
 LAT/LONG: 40.0517 / 78.6582

CLIENT: Burgess Niple, Inc.
 CONTACT: Anna Dougherty
 INQUIRY #: 2420965.2s
 DATE: February 13, 2009 11:35 am

DETAIL MAP - 2420965.2s

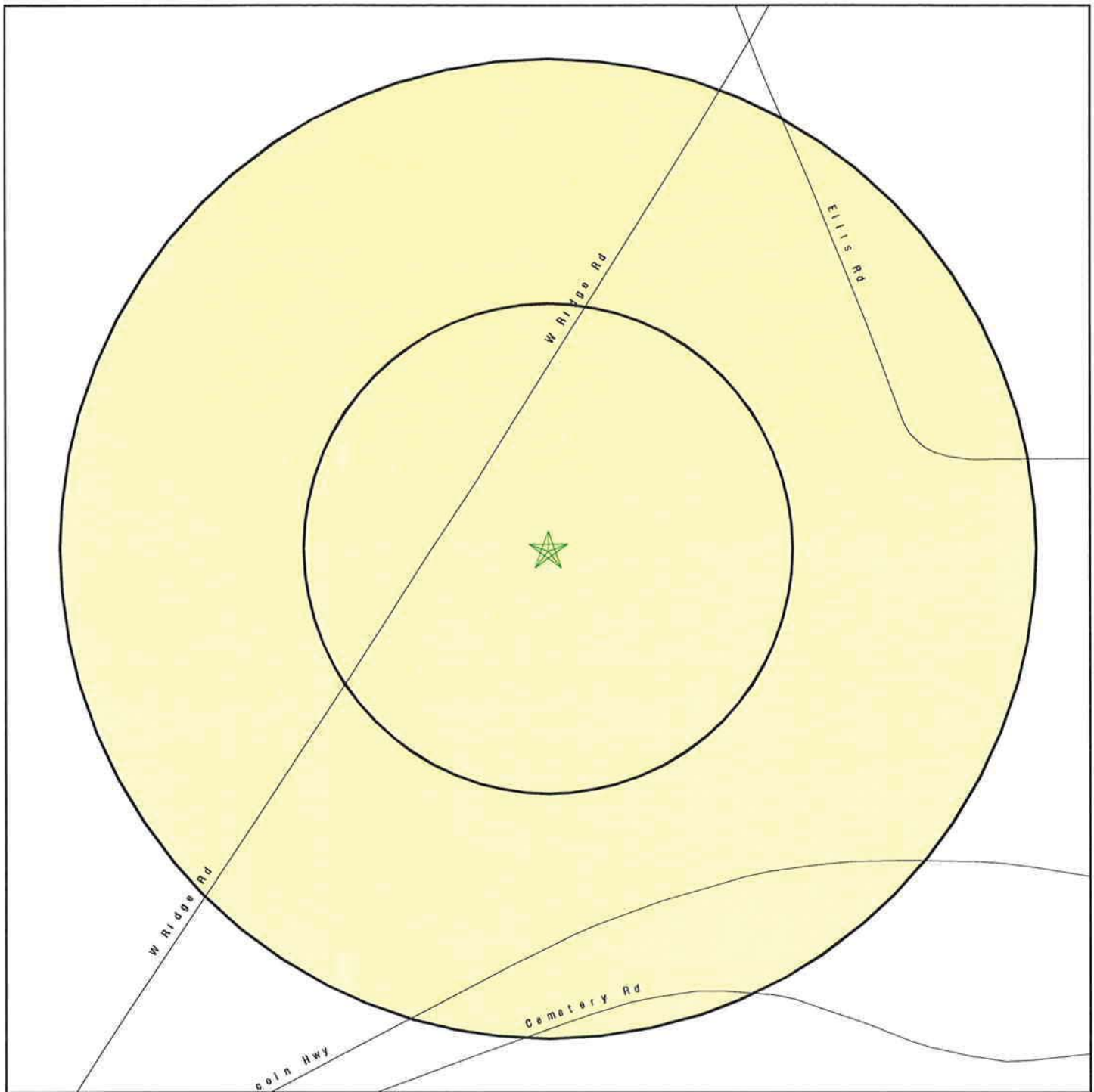

- ★ Target Property
- ▲ Sites at elevations higher than or equal to the target property
- ◆ Sites at elevations lower than the target property
- ▲ Manufactured Gas Plants
- ▲ Sensitive Receptors
- National Priority List Sites
- Dept. Defense Sites

- Indian Reservations BIA
- Oil & Gas pipelines
- 100-year flood zone
- 500-year flood zone

0 1/16 1/8 1/4 Miles



This report includes Interactive Map Layers to display and/or hide map information. The legend includes only those icons for the default map view.

SITE NAME: Schellsburg Liberty Towers Site
 ADDRESS: 200 West Ridge Road
 Schellsburg PA 15559
 LAT/LONG: 40.0517 / 78.6582

CLIENT: Burgess Niple, Inc.
 CONTACT: Anna Dougherty
 INQUIRY #: 2420965.2s
 DATE: February 13, 2009 11:35 am

MAP FINDINGS SUMMARY

Database	Target Property	Search Distance (Miles)	< 1/8	1/8 - 1/4	1/4 - 1/2	1/2 - 1	> 1	Total Plotted
<u>STANDARD ENVIRONMENTAL RECORDS</u>								
<i>Federal NPL site list</i>								
NPL		1.000	0	0	0	0	NR	0
Proposed NPL		1.000	0	0	0	0	NR	0
NPL LIENS		TP	NR	NR	NR	NR	NR	0
<i>Federal Delisted NPL site list</i>								
Delisted NPL		1.000	0	0	0	0	NR	0
<i>Federal CERCLIS list</i>								
CERCLIS		0.500	0	0	0	NR	NR	0
<i>Federal CERCLIS NFRAP site List</i>								
CERC-NFRAP		0.500	0	0	0	NR	NR	0
<i>Federal RCRA CORRACTS facilities list</i>								
CORRACTS		1.000	0	0	0	0	NR	0
<i>Federal RCRA non-CORRACTS TSD facilities list</i>								
RCRA-TSDF		0.500	0	0	0	NR	NR	0
<i>Federal RCRA generators list</i>								
RCRA-LQG		0.250	0	0	NR	NR	NR	0
RCRA-SQG		0.250	0	0	NR	NR	NR	0
RCRA-CESQG		0.250	0	0	NR	NR	NR	0
<i>Federal institutional controls / engineering controls registries</i>								
US ENG CONTROLS		0.500	0	0	0	NR	NR	0
US INST CONTROL		0.500	0	0	0	NR	NR	0
<i>Federal ERNS list</i>								
ERNS		TP	NR	NR	NR	NR	NR	0
<i>State- and tribal - equivalent NPL</i>								
SHWS		1.000	0	0	0	0	NR	0
HSCA		1.000	0	0	0	0	NR	0
<i>State and tribal landfill and/or solid waste disposal site lists</i>								
SWF/LF		0.500	0	0	0	NR	NR	0
<i>State and tribal leaking storage tank lists</i>								
LUST		0.500	0	0	0	NR	NR	0
UNREG LTANKS		0.500	0	0	0	NR	NR	0
LAST		0.500	0	0	0	NR	NR	0
INDIAN LUST		0.500	0	0	0	NR	NR	0
<i>State and tribal registered storage tank lists</i>								
UST		0.250	0	0	NR	NR	NR	0

MAP FINDINGS SUMMARY

Database	Target Property	Search Distance (Miles)	< 1/8	1/8 - 1/4	1/4 - 1/2	1/2 - 1	> 1	Total Plotted
AST		0.250	0	0	NR	NR	NR	0
INDIAN UST		0.250	0	0	NR	NR	NR	0
State and tribal institutional control / engineering control registries								
ENG CONTROLS		0.500	0	0	0	NR	NR	0
INST CONTROL		0.500	0	0	0	NR	NR	0
State and tribal voluntary cleanup sites								
INDIAN VCP		0.500	0	0	0	NR	NR	0
VCP		0.500	0	0	0	NR	NR	0
State and tribal Brownfields sites								
BROWNFIELDS		0.500	0	0	0	NR	NR	0
ADDITIONAL ENVIRONMENTAL RECORDS								
Local Brownfield lists								
US BROWNFIELDS		0.500	0	0	0	NR	NR	0
Local Lists of Landfill / Solid Waste Disposal Sites								
ODI		0.500	0	0	0	NR	NR	0
DEBRIS REGION 9		0.500	0	0	0	NR	NR	0
HIST LF		0.500	0	0	0	NR	NR	0
INDIAN ODI		0.500	0	0	0	NR	NR	0
Local Lists of Hazardous waste / Contaminated Sites								
US CDL		TP	NR	NR	NR	NR	NR	0
Local Lists of Registered Storage Tanks								
ARCHIVE UST		0.250	0	0	NR	NR	NR	0
ARCHIVE AST		TP	NR	NR	NR	NR	NR	0
Local Land Records								
LIENS 2		TP	NR	NR	NR	NR	NR	0
LUCIS		0.500	0	0	0	NR	NR	0
ACT 2-DEED		0.500	0	0	0	NR	NR	0
Records of Emergency Release Reports								
HMIRS		TP	NR	NR	NR	NR	NR	0
SPILLS		TP	NR	NR	NR	NR	NR	0
Other Ascertainable Records								
RCRA-NonGen		0.250	0	0	NR	NR	NR	0
DOT OPS		TP	NR	NR	NR	NR	NR	0
DOD		1.000	0	0	0	0	NR	0
FUDS		1.000	0	0	0	0	NR	0
CONSENT		1.000	0	0	0	0	NR	0

MAP FINDINGS SUMMARY

Database	Target Property	Search Distance (Miles)	< 1/8	1/8 - 1/4	1/4 - 1/2	1/2 - 1	> 1	Total Plotted
ROD		1.000	0	0	0	0	NR	0
UMTRA		0.500	0	0	0	NR	NR	0
MINES		0.250	0	0	NR	NR	NR	0
TRIS	TP		NR	NR	NR	NR	NR	0
TSCA	TP		NR	NR	NR	NR	NR	0
FTTS	TP		NR	NR	NR	NR	NR	0
HIST FTTS	TP		NR	NR	NR	NR	NR	0
SSTS	TP		NR	NR	NR	NR	NR	0
ICIS	TP		NR	NR	NR	NR	NR	0
PADS	TP		NR	NR	NR	NR	NR	0
MLTS	TP		NR	NR	NR	NR	NR	0
RADINFO	TP		NR	NR	NR	NR	NR	0
FINDS	TP		NR	NR	NR	NR	NR	0
RAATS	TP		NR	NR	NR	NR	NR	0
MANIFEST		0.250	0	0	NR	NR	NR	0
DRYCLEANERS		0.250	0	0	NR	NR	NR	0
AIRS	TP		NR	NR	NR	NR	NR	0
INDIAN RESERV		1.000	0	0	0	0	NR	0
SCRD DRYCLEANERS		0.500	0	0	0	NR	NR	0
PWS	TP		NR	NR	NR	NR	NR	0

EDR PROPRIETARY RECORDS

EDR Proprietary Records

Manufactured Gas Plants	1.000	0	0	0	0	NR	0
-------------------------	-------	---	---	---	---	----	---

NOTES:

TP = Target Property

NR = Not Requested at this Search Distance

Sites may be listed in more than one database

Map ID
Direction
Distance
Elevation

MAP FINDINGS

Site

Database(s)

EDR ID Number
EPA ID Number

NO SITES FOUND

ORPHAN SUMMARY

City	EDR ID	Site Name	Site Address	Zip	Database(s)
SHELLSBURG	1000572016	SHELLSBURG AMOCO	RT 30	15559	RCRA-SQG, FINDS
SHELLSBURG	1004772423	DAN AND SONS BODY SHOP	RTE 30 E BOX 326	15559	FINDS, RCRA-CESQG
SHELLSBURG	1007674524	SHELLSBURG VALLEY VOL FIRE DEPT	MAIN ST	15559	FINDS
SHELLSBURG	U001454961	GILBERT BROS	US ROUTE 30	15559	ARCHIVE UST

GOVERNMENT RECORDS SEARCHED / DATA CURRENCY TRACKING

To maintain currency of the following federal and state databases, EDR contacts the appropriate governmental agency on a monthly or quarterly basis, as required.

Number of Days to Update: Provides confirmation that EDR is reporting records that have been updated within 90 days from the date the government agency made the information available to the public.

STANDARD ENVIRONMENTAL RECORDS

Federal NPL site list

NPL: National Priority List

National Priorities List (Superfund). The NPL is a subset of CERCLIS and identifies over 1,200 sites for priority cleanup under the Superfund Program. NPL sites may encompass relatively large areas. As such, EDR provides polygon coverage for over 1,000 NPL site boundaries produced by EPA's Environmental Photographic Interpretation Center (EPIC) and regional EPA offices.

Date of Government Version: 09/29/2008	Source: EPA
Date Data Arrived at EDR: 10/10/2008	Telephone: N/A
Date Made Active in Reports: 11/19/2008	Last EDR Contact: 01/26/2009
Number of Days to Update: 40	Next Scheduled EDR Contact: 04/27/2009
	Data Release Frequency: Quarterly

NPL Site Boundaries

Sources:

EPA's Environmental Photographic Interpretation Center (EPIC)
Telephone: 202-564-7333

EPA Region 1 Telephone 617-918-1143	EPA Region 6 Telephone: 214-655-6659
EPA Region 3 Telephone 215-814-5418	EPA Region 7 Telephone: 913-551-7247
EPA Region 4 Telephone 404-562-8033	EPA Region 8 Telephone: 303-312-6774
EPA Region 5 Telephone 312-886-6686	EPA Region 9 Telephone: 415-947-4246
EPA Region 10 Telephone 206-553-8665	

Proposed NPL: Proposed National Priority List Sites

A site that has been proposed for listing on the National Priorities List through the issuance of a proposed rule in the Federal Register. EPA then accepts public comments on the site, responds to the comments, and places on the NPL those sites that continue to meet the requirements for listing.

Date of Government Version: 09/29/2008	Source: EPA
Date Data Arrived at EDR: 10/10/2008	Telephone: N/A
Date Made Active in Reports: 11/19/2008	Last EDR Contact: 01/26/2009
Number of Days to Update: 40	Next Scheduled EDR Contact: 04/27/2009
	Data Release Frequency: Quarterly

NPL LIENS: Federal Superfund Liens

Federal Superfund Liens. Under the authority granted the USEPA by CERCLA of 1980, the USEPA has the authority to file liens against real property in order to recover remedial action expenditures or when the property owner received notification of potential liability. USEPA compiles a listing of filed notices of Superfund Liens.

Date of Government Version: 10/15/1991	Source: EPA
Date Data Arrived at EDR: 02/02/1994	Telephone: 202-564-4267
Date Made Active in Reports: 03/30/1994	Last EDR Contact: 11/17/2008
Number of Days to Update: 56	Next Scheduled EDR Contact: 02/16/2009
	Data Release Frequency: No Update Planned

GOVERNMENT RECORDS SEARCHED / DATA CURRENCY TRACKING

Federal Delisted NPL site list

DELISTED NPL: National Priority List Deletions

The National Oil and Hazardous Substances Pollution Contingency Plan (NCP) establishes the criteria that the EPA uses to delete sites from the NPL. In accordance with 40 CFR 300.425.(e), sites may be deleted from the NPL where no further response is appropriate.

Date of Government Version: 09/29/2008	Source: EPA
Date Data Arrived at EDR: 10/10/2008	Telephone: N/A
Date Made Active in Reports: 11/19/2008	Last EDR Contact: 01/26/2009
Number of Days to Update: 40	Next Scheduled EDR Contact: 04/27/2009
	Data Release Frequency: Quarterly

Federal CERCLIS list

CERCLIS: Comprehensive Environmental Response, Compensation, and Liability Information System

CERCLIS contains data on potentially hazardous waste sites that have been reported to the USEPA by states, municipalities, private companies and private persons, pursuant to Section 103 of the Comprehensive Environmental Response, Compensation, and Liability Act (CERCLA). CERCLIS contains sites which are either proposed to or on the National Priorities List (NPL) and sites which are in the screening and assessment phase for possible inclusion on the NPL.

Date of Government Version: 10/07/2008	Source: EPA
Date Data Arrived at EDR: 10/16/2008	Telephone: 703-412-9810
Date Made Active in Reports: 12/08/2008	Last EDR Contact: 01/30/2009
Number of Days to Update: 53	Next Scheduled EDR Contact: 04/13/2009
	Data Release Frequency: Quarterly

Federal CERCLIS NFRAP site List

CERCLIS-NFRAP: CERCLIS No Further Remedial Action Planned

Archived sites are sites that have been removed and archived from the inventory of CERCLIS sites. Archived status indicates that, to the best of EPA's knowledge, assessment at a site has been completed and that EPA has determined no further steps will be taken to list this site on the National Priorities List (NPL), unless information indicates this decision was not appropriate or other considerations require a recommendation for listing at a later time. This decision does not necessarily mean that there is no hazard associated with a given site; it only means that, based upon available information, the location is not judged to be a potential NPL site.

Date of Government Version: 12/03/2007	Source: EPA
Date Data Arrived at EDR: 12/06/2007	Telephone: 703-412-9810
Date Made Active in Reports: 02/20/2008	Last EDR Contact: 01/26/2009
Number of Days to Update: 76	Next Scheduled EDR Contact: 03/16/2009
	Data Release Frequency: Quarterly

Federal RCRA CORRACTS facilities list

CORRACTS: Corrective Action Report

CORRACTS identifies hazardous waste handlers with RCRA corrective action activity.

Date of Government Version: 09/11/2008	Source: EPA
Date Data Arrived at EDR: 09/19/2008	Telephone: 800-424-9346
Date Made Active in Reports: 10/16/2008	Last EDR Contact: 12/01/2008
Number of Days to Update: 27	Next Scheduled EDR Contact: 03/02/2009
	Data Release Frequency: Quarterly

Federal RCRA non-CORRACTS TSD facilities list

RCRA-TSDF: RCRA - Transporters, Storage and Disposal

RCRAInfo is EPA's comprehensive information system, providing access to data supporting the Resource Conservation and Recovery Act (RCRA) of 1976 and the Hazardous and Solid Waste Amendments (HSWA) of 1984. The database includes selective information on sites which generate, transport, store, treat and/or dispose of hazardous waste as defined by the Resource Conservation and Recovery Act (RCRA). Transporters are individuals or entities that move hazardous waste from the generator offsite to a facility that can recycle, treat, store, or dispose of the waste. TSDFs treat, store, or dispose of the waste.

GOVERNMENT RECORDS SEARCHED / DATA CURRENCY TRACKING

Date of Government Version: 09/10/2008
Date Data Arrived at EDR: 09/23/2008
Date Made Active in Reports: 10/16/2008
Number of Days to Update: 23

Source: Environmental Protection Agency
Telephone: 800-438-2474
Last EDR Contact: 02/06/2009
Next Scheduled EDR Contact: 02/16/2009
Data Release Frequency: Quarterly

Federal RCRA generators list

RCRA-LQG: RCRA - Large Quantity Generators

RCRAInfo is EPA's comprehensive information system, providing access to data supporting the Resource Conservation and Recovery Act (RCRA) of 1976 and the Hazardous and Solid Waste Amendments (HSWA) of 1984. The database includes selective information on sites which generate, transport, store, treat and/or dispose of hazardous waste as defined by the Resource Conservation and Recovery Act (RCRA). Large quantity generators (LQGs) generate over 1,000 kilograms (kg) of hazardous waste, or over 1 kg of acutely hazardous waste per month.

Date of Government Version: 09/10/2008
Date Data Arrived at EDR: 09/23/2008
Date Made Active in Reports: 10/16/2008
Number of Days to Update: 23

Source: Environmental Protection Agency
Telephone: 800-438-2474
Last EDR Contact: 02/06/2009
Next Scheduled EDR Contact: 02/16/2009
Data Release Frequency: Quarterly

RCRA-SQG: RCRA - Small Quantity Generators

RCRAInfo is EPA's comprehensive information system, providing access to data supporting the Resource Conservation and Recovery Act (RCRA) of 1976 and the Hazardous and Solid Waste Amendments (HSWA) of 1984. The database includes selective information on sites which generate, transport, store, treat and/or dispose of hazardous waste as defined by the Resource Conservation and Recovery Act (RCRA). Small quantity generators (SQGs) generate between 100 kg and 1,000 kg of hazardous waste per month.

Date of Government Version: 09/10/2008
Date Data Arrived at EDR: 09/23/2008
Date Made Active in Reports: 10/16/2008
Number of Days to Update: 23

Source: Environmental Protection Agency
Telephone: 800-438-2474
Last EDR Contact: 02/06/2009
Next Scheduled EDR Contact: 02/16/2009
Data Release Frequency: Quarterly

RCRA-CESQG: RCRA - Conditionally Exempt Small Quantity Generators

RCRAInfo is EPA's comprehensive information system, providing access to data supporting the Resource Conservation and Recovery Act (RCRA) of 1976 and the Hazardous and Solid Waste Amendments (HSWA) of 1984. The database includes selective information on sites which generate, transport, store, treat and/or dispose of hazardous waste as defined by the Resource Conservation and Recovery Act (RCRA). Conditionally exempt small quantity generators (CESQGs) generate less than 100 kg of hazardous waste, or less than 1 kg of acutely hazardous waste per month.

Date of Government Version: 09/10/2008
Date Data Arrived at EDR: 09/23/2008
Date Made Active in Reports: 10/16/2008
Number of Days to Update: 23

Source: Environmental Protection Agency
Telephone: 800-438-2474
Last EDR Contact: 02/06/2009
Next Scheduled EDR Contact: 02/16/2009
Data Release Frequency: Varies

Federal institutional controls / engineering controls registries

US ENG CONTROLS: Engineering Controls Sites List

A listing of sites with engineering controls in place. Engineering controls include various forms of caps, building foundations, liners, and treatment methods to create pathway elimination for regulated substances to enter environmental media or effect human health.

Date of Government Version: 10/06/2008
Date Data Arrived at EDR: 10/17/2008
Date Made Active in Reports: 12/08/2008
Number of Days to Update: 52

Source: Environmental Protection Agency
Telephone: 703-603-0695
Last EDR Contact: 12/29/2008
Next Scheduled EDR Contact: 03/30/2009
Data Release Frequency: Varies

GOVERNMENT RECORDS SEARCHED / DATA CURRENCY TRACKING

US INST CONTROL: Sites with Institutional Controls

A listing of sites with institutional controls in place. Institutional controls include administrative measures, such as groundwater use restrictions, construction restrictions, property use restrictions, and post remediation care requirements intended to prevent exposure to contaminants remaining on site. Deed restrictions are generally required as part of the institutional controls.

Date of Government Version: 10/06/2008
Date Data Arrived at EDR: 10/17/2008
Date Made Active in Reports: 12/08/2008
Number of Days to Update: 52

Source: Environmental Protection Agency
Telephone: 703-603-0695
Last EDR Contact: 12/29/2008
Next Scheduled EDR Contact: 03/30/2009
Data Release Frequency: Varies

Federal ERNS list

ERNS: Emergency Response Notification System

Emergency Response Notification System. ERNS records and stores information on reported releases of oil and hazardous substances.

Date of Government Version: 12/31/2007
Date Data Arrived at EDR: 01/23/2008
Date Made Active in Reports: 03/17/2008
Number of Days to Update: 54

Source: National Response Center, United States Coast Guard
Telephone: 202-267-2180
Last EDR Contact: 01/30/2009
Next Scheduled EDR Contact: 04/19/2009
Data Release Frequency: Annually

State- and tribal - equivalent NPL

SHWS: Hazardous Sites Cleanup Act Site List

The Hazardous Sites Cleanup Act Site List includes sites listed on PA Priority List, sites delisted from PA Priority List, Interim Response Completed sites, and Sites Being Studied or Response Being Planned.

Date of Government Version: 07/03/2008
Date Data Arrived at EDR: 08/13/2008
Date Made Active in Reports: 09/04/2008
Number of Days to Update: 22

Source: Department Environmental Protection
Telephone: 717-783-7816
Last EDR Contact: 02/11/2009
Next Scheduled EDR Contact: 05/11/2009
Data Release Frequency: Semi-Annually

HSCA: HSCA Remedial Sites Listing

A list of remedial sites on the PA Priority List. This is the PA state equivalent of the federal NPL superfund list.

Date of Government Version: 09/01/2008
Date Data Arrived at EDR: 11/12/2008
Date Made Active in Reports: 12/12/2008
Number of Days to Update: 30

Source: Department of Environmental Protection
Telephone: 717-783-7816
Last EDR Contact: 02/13/2009
Next Scheduled EDR Contact: 05/11/2009
Data Release Frequency: Varies

State and tribal landfill and/or solid waste disposal site lists

SWF/LF: Operating Facilities

The listing includes Municipal Waste Landfills, Construction/Demolition Waste Landfills and Waste-to-Energy Facilities.

Date of Government Version: 09/08/2008
Date Data Arrived at EDR: 10/06/2008
Date Made Active in Reports: 10/23/2008
Number of Days to Update: 17

Source: Department of Environmental Protection
Telephone: 717-787-7564
Last EDR Contact: 09/17/2008
Next Scheduled EDR Contact: 12/15/2008
Data Release Frequency: Semi-Annually

State and tribal leaking storage tank lists

GOVERNMENT RECORDS SEARCHED / DATA CURRENCY TRACKING

LUST: Storage Tank Release Sites

Leaking Underground Storage Tank Incident Reports. LUST records contain an inventory of reported leaking underground storage tank incidents. Not all states maintain these records, and the information stored varies by state.

Date of Government Version: 10/06/2008	Source: Department of Environmental Protection
Date Data Arrived at EDR: 10/09/2008	Telephone: 717-783-7509
Date Made Active in Reports: 10/23/2008	Last EDR Contact: 01/09/2009
Number of Days to Update: 14	Next Scheduled EDR Contact: 04/06/2009
	Data Release Frequency: Semi-Annually

UNREG LTANKS: Unregulated Tank Cases

Leaking storage tank cases from unregulated storage tanks.

Date of Government Version: 04/12/2002	Source: Department of Environmental Protection
Date Data Arrived at EDR: 08/14/2003	Telephone: 717-783-7509
Date Made Active in Reports: 08/29/2003	Last EDR Contact: 08/14/2003
Number of Days to Update: 15	Next Scheduled EDR Contact: N/A
	Data Release Frequency: No Update Planned

LAST: Storage Tank Release Sites

Leaking Aboveground Storage Tank Incident Reports.

Date of Government Version: 10/06/2008	Source: Department of Environmental Protection
Date Data Arrived at EDR: 10/09/2008	Telephone: 717-783-7509
Date Made Active in Reports: 10/23/2008	Last EDR Contact: 01/09/2009
Number of Days to Update: 14	Next Scheduled EDR Contact: 04/06/2009
	Data Release Frequency: Semi-Annually

INDIAN LUST R1: Leaking Underground Storage Tanks on Indian Land

A listing of leaking underground storage tank locations on Indian Land.

Date of Government Version: 03/12/2008	Source: EPA Region 1
Date Data Arrived at EDR: 03/14/2008	Telephone: 617-918-1313
Date Made Active in Reports: 03/20/2008	Last EDR Contact: 11/17/2008
Number of Days to Update: 6	Next Scheduled EDR Contact: 02/16/2009
	Data Release Frequency: Varies

INDIAN LUST R4: Leaking Underground Storage Tanks on Indian Land

LUSTs on Indian land in Florida, Mississippi and North Carolina.

Date of Government Version: 06/06/2008	Source: EPA Region 4
Date Data Arrived at EDR: 10/09/2008	Telephone: 404-562-8677
Date Made Active in Reports: 11/19/2008	Last EDR Contact: 11/17/2008
Number of Days to Update: 41	Next Scheduled EDR Contact: 02/16/2009
	Data Release Frequency: Semi-Annually

INDIAN LUST R6: Leaking Underground Storage Tanks on Indian Land

LUSTs on Indian land in New Mexico and Oklahoma.

Date of Government Version: 11/25/2008	Source: EPA Region 6
Date Data Arrived at EDR: 11/26/2008	Telephone: 214-665-6597
Date Made Active in Reports: 12/23/2008	Last EDR Contact: 11/17/2008
Number of Days to Update: 27	Next Scheduled EDR Contact: 02/16/2009
	Data Release Frequency: Varies

INDIAN LUST R7: Leaking Underground Storage Tanks on Indian Land

LUSTs on Indian land in Iowa, Kansas, and Nebraska

Date of Government Version: 04/01/2008	Source: EPA Region 7
Date Data Arrived at EDR: 12/03/2008	Telephone: 913-551-7003
Date Made Active in Reports: 12/23/2008	Last EDR Contact: 11/19/2008
Number of Days to Update: 20	Next Scheduled EDR Contact: 02/16/2009
	Data Release Frequency: Varies

GOVERNMENT RECORDS SEARCHED / DATA CURRENCY TRACKING

INDIAN LUST R8: Leaking Underground Storage Tanks on Indian Land

LUSTs on Indian land in Colorado, Montana, North Dakota, South Dakota, Utah and Wyoming.

Date of Government Version: 12/02/2008
Date Data Arrived at EDR: 12/04/2008
Date Made Active in Reports: 12/23/2008
Number of Days to Update: 19

Source: EPA Region 8
Telephone: 303-312-6271
Last EDR Contact: 11/17/2008
Next Scheduled EDR Contact: 02/16/2009
Data Release Frequency: Quarterly

INDIAN LUST R9: Leaking Underground Storage Tanks on Indian Land

LUSTs on Indian land in Arizona, California, New Mexico and Nevada

Date of Government Version: 10/10/2008
Date Data Arrived at EDR: 10/10/2008
Date Made Active in Reports: 10/16/2008
Number of Days to Update: 6

Source: Environmental Protection Agency
Telephone: 415-972-3372
Last EDR Contact: 11/17/2008
Next Scheduled EDR Contact: 02/16/2009
Data Release Frequency: Quarterly

INDIAN LUST R10: Leaking Underground Storage Tanks on Indian Land

LUSTs on Indian land in Alaska, Idaho, Oregon and Washington.

Date of Government Version: 11/18/2008
Date Data Arrived at EDR: 11/19/2008
Date Made Active in Reports: 12/23/2008
Number of Days to Update: 34

Source: EPA Region 10
Telephone: 206-553-2857
Last EDR Contact: 11/17/2008
Next Scheduled EDR Contact: 02/16/2009
Data Release Frequency: Quarterly

State and tribal registered storage tank lists

UST: Listing of Pennsylvania Regulated Underground Storage Tanks

Registered Underground Storage Tanks. UST's are regulated under Subtitle I of the Resource Conservation and Recovery Act (RCRA) and must be registered with the state department responsible for administering the UST program. Available information varies by state program.

Date of Government Version: 09/02/2008
Date Data Arrived at EDR: 10/09/2008
Date Made Active in Reports: 10/23/2008
Number of Days to Update: 14

Source: Department of Environmental Protection
Telephone: 717-772-5599
Last EDR Contact: 10/09/2008
Next Scheduled EDR Contact: 01/05/2009
Data Release Frequency: Varies

AST: Listing of Pennsylvania Regulated Aboveground Storage Tanks

Registered Aboveground Storage Tanks.

Date of Government Version: 09/02/2008
Date Data Arrived at EDR: 10/09/2008
Date Made Active in Reports: 10/23/2008
Number of Days to Update: 14

Source: Department of Environmental Protection
Telephone: 717-772-5599
Last EDR Contact: 10/09/2008
Next Scheduled EDR Contact: 01/05/2009
Data Release Frequency: Varies

INDIAN UST R7: Underground Storage Tanks on Indian Land

The Indian Underground Storage Tank (UST) database provides information about underground storage tanks on Indian land in EPA Region 7 (Iowa, Kansas, Missouri, Nebraska, and 9 Tribal Nations).

Date of Government Version: 06/01/2007
Date Data Arrived at EDR: 06/14/2007
Date Made Active in Reports: 07/05/2007
Number of Days to Update: 21

Source: EPA Region 7
Telephone: 913-551-7003
Last EDR Contact: 11/19/2008
Next Scheduled EDR Contact: 02/16/2009
Data Release Frequency: Varies

GOVERNMENT RECORDS SEARCHED / DATA CURRENCY TRACKING

INDIAN UST R6: Underground Storage Tanks on Indian Land

The Indian Underground Storage Tank (UST) database provides information about underground storage tanks on Indian land in EPA Region 6 (Louisiana, Arkansas, Oklahoma, New Mexico, Texas and 65 Tribes).

Date of Government Version: 11/25/2008	Source: EPA Region 6
Date Data Arrived at EDR: 11/26/2008	Telephone: 214-665-7591
Date Made Active in Reports: 12/23/2008	Last EDR Contact: 11/17/2008
Number of Days to Update: 27	Next Scheduled EDR Contact: 02/16/2009
	Data Release Frequency: Semi-Annually

INDIAN UST R5: Underground Storage Tanks on Indian Land

The Indian Underground Storage Tank (UST) database provides information about underground storage tanks on Indian land in EPA Region 5 (Michigan, Minnesota and Wisconsin and Tribal Nations).

Date of Government Version: 09/08/2008	Source: EPA Region 5
Date Data Arrived at EDR: 09/19/2008	Telephone: 312-886-6136
Date Made Active in Reports: 10/16/2008	Last EDR Contact: 11/17/2008
Number of Days to Update: 27	Next Scheduled EDR Contact: 02/16/2009
	Data Release Frequency: Varies

INDIAN UST R4: Underground Storage Tanks on Indian Land

The Indian Underground Storage Tank (UST) database provides information about underground storage tanks on Indian land in EPA Region 4 (Alabama, Florida, Georgia, Kentucky, Mississippi, North Carolina, South Carolina, Tennessee and Tribal Nations)

Date of Government Version: 06/06/2008	Source: EPA Region 4
Date Data Arrived at EDR: 10/09/2008	Telephone: 404-562-9424
Date Made Active in Reports: 11/19/2008	Last EDR Contact: 11/17/2008
Number of Days to Update: 41	Next Scheduled EDR Contact: 02/16/2009
	Data Release Frequency: Semi-Annually

INDIAN UST R1: Underground Storage Tanks on Indian Land

The Indian Underground Storage Tank (UST) database provides information about underground storage tanks on Indian land in EPA Region 1 (Connecticut, Maine, Massachusetts, New Hampshire, Rhode Island, Vermont and ten Tribal Nations).

Date of Government Version: 03/12/2008	Source: EPA, Region 1
Date Data Arrived at EDR: 03/14/2008	Telephone: 617-918-1313
Date Made Active in Reports: 03/20/2008	Last EDR Contact: 11/17/2008
Number of Days to Update: 6	Next Scheduled EDR Contact: 02/16/2009
	Data Release Frequency: Varies

INDIAN UST R8: Underground Storage Tanks on Indian Land

The Indian Underground Storage Tank (UST) database provides information about underground storage tanks on Indian land in EPA Region 8 (Colorado, Montana, North Dakota, South Dakota, Utah, Wyoming and 27 Tribal Nations).

Date of Government Version: 12/01/2008	Source: EPA Region 8
Date Data Arrived at EDR: 12/04/2008	Telephone: 303-312-6137
Date Made Active in Reports: 12/23/2008	Last EDR Contact: 11/17/2008
Number of Days to Update: 19	Next Scheduled EDR Contact: 02/16/2009
	Data Release Frequency: Quarterly

INDIAN UST R10: Underground Storage Tanks on Indian Land

The Indian Underground Storage Tank (UST) database provides information about underground storage tanks on Indian land in EPA Region 10 (Alaska, Idaho, Oregon, Washington, and Tribal Nations).

Date of Government Version: 11/18/2008	Source: EPA Region 10
Date Data Arrived at EDR: 11/19/2008	Telephone: 206-553-2857
Date Made Active in Reports: 12/23/2008	Last EDR Contact: 11/17/2008
Number of Days to Update: 34	Next Scheduled EDR Contact: 02/16/2009
	Data Release Frequency: Quarterly

GOVERNMENT RECORDS SEARCHED / DATA CURRENCY TRACKING

INDIAN UST R9: Underground Storage Tanks on Indian Land

The Indian Underground Storage Tank (UST) database provides information about underground storage tanks on Indian land in EPA Region 9 (Arizona, California, Hawaii, Nevada, the Pacific Islands, and Tribal Nations).

Date of Government Version: 09/05/2008	Source: EPA Region 9
Date Data Arrived at EDR: 09/19/2008	Telephone: 415-972-3368
Date Made Active in Reports: 10/16/2008	Last EDR Contact: 11/17/2008
Number of Days to Update: 27	Next Scheduled EDR Contact: 02/16/2009
	Data Release Frequency: Quarterly

State and tribal institutional control / engineering control registries

ENG CONTROLS: Engineering Controls Site Listing

Under the Land Recycling Act (Act 2) persons who perform a site cleanup using the site-specific standard or the special industrial area standard may use engineering or institutional controls as part of the response action. Engineering controls include various forms of caps, building foundations, liners, and treatment methods to create pathway elimination for regulated substances to enter environmental media or effect human health.

Date of Government Version: 05/15/2008	Source: Department of Environmental Protection
Date Data Arrived at EDR: 05/16/2008	Telephone: 717-783-9470
Date Made Active in Reports: 06/12/2008	Last EDR Contact: 02/11/2009
Number of Days to Update: 27	Next Scheduled EDR Contact: 05/11/2009
	Data Release Frequency: Varies

INST CONTROL: Institutional Controls Site Listing

Under the Land Recycling Act (Act 2) persons who perform a site cleanup using the site-specific standard or the special industrial area standard may use engineering or institutional controls as part of the response action. Institutional controls include administrative measures, such as groundwater use restrictions, construction restrictions, property use restrictions, and post remediation care requirements intended to prevent exposure to contaminants remaining on site. Deed restrictions are generally required as part of the institutional controls.

Date of Government Version: 05/15/2008	Source: Department of Environmental Protection
Date Data Arrived at EDR: 05/16/2008	Telephone: 717-783-9470
Date Made Active in Reports: 06/12/2008	Last EDR Contact: 02/11/2009
Number of Days to Update: 27	Next Scheduled EDR Contact: 05/11/2009
	Data Release Frequency: Varies

State and tribal voluntary cleanup sites

INDIAN VCP R7: Voluntary Cleanup Priority Listing

A listing of voluntary cleanup priority sites located on Indian Land located in Region 7.

Date of Government Version: 03/20/2008	Source: EPA, Region 7
Date Data Arrived at EDR: 04/22/2008	Telephone: 913-551-7365
Date Made Active in Reports: 05/19/2008	Last EDR Contact: 01/19/2009
Number of Days to Update: 27	Next Scheduled EDR Contact: 04/19/2009
	Data Release Frequency: Varies

INDIAN VCP R1: Voluntary Cleanup Priority Listing

A listing of voluntary cleanup priority sites located on Indian Land located in Region 1.

Date of Government Version: 04/02/2008	Source: EPA, Region 1
Date Data Arrived at EDR: 04/22/2008	Telephone: 617-918-1102
Date Made Active in Reports: 05/19/2008	Last EDR Contact: 01/19/2009
Number of Days to Update: 27	Next Scheduled EDR Contact: 04/19/2009
	Data Release Frequency: Varies

VCP: Voluntary Cleanup Program Sites

Sites involved in the Voluntary Cleanup Program

GOVERNMENT RECORDS SEARCHED / DATA CURRENCY TRACKING

Date of Government Version: 08/25/2008
Date Data Arrived at EDR: 08/25/2008
Date Made Active in Reports: 09/04/2008
Number of Days to Update: 10

Source: Department of Environmental Protection
Telephone: 717-783-2388
Last EDR Contact: 02/02/2009
Next Scheduled EDR Contact: 02/09/2009
Data Release Frequency: Semi-Annually

State and tribal Brownfields sites

BROWNFIELDS: Brownfields Sites

Brownfields are generally defined as abandoned or underused industrial or commercial properties where redevelopment is complicated by actual or perceived environmental contamination. Brownfields vary in size, location, age and past use. They can range from a small, abandoned corner gas station to a large, multi-acre former manufacturing plant that has been closed for years.

Date of Government Version: 02/07/2008
Date Data Arrived at EDR: 02/07/2008
Date Made Active in Reports: 02/11/2008
Number of Days to Update: 4

Source: Department of Environmental Protection
Telephone: 717-783-1566
Last EDR Contact: 02/12/2009
Next Scheduled EDR Contact: 05/11/2009
Data Release Frequency: Varies

ADDITIONAL ENVIRONMENTAL RECORDS

Local Brownfield lists

US BROWNFIELDS: A Listing of Brownfields Sites

Included in the listing are brownfields properties addresses by Cooperative Agreement Recipients and brownfields properties addressed by Targeted Brownfields Assessments. Targeted Brownfields Assessments-EPA's Targeted Brownfields Assessments (TBA) program is designed to help states, tribes, and municipalities--especially those without EPA Brownfields Assessment Demonstration Pilots--minimize the uncertainties of contamination often associated with brownfields. Under the TBA program, EPA provides funding and/or technical assistance for environmental assessments at brownfields sites throughout the country. Targeted Brownfields Assessments supplement and work with other efforts under EPA's Brownfields Initiative to promote cleanup and redevelopment of brownfields. Cooperative Agreement Recipients-States, political subdivisions, territories, and Indian tribes become Brownfields Cleanup Revolving Loan Fund (BCRLF) cooperative agreement recipients when they enter into BCRLF cooperative agreements with the U.S. EPA. EPA selects BCRLF cooperative agreement recipients based on a proposal and application process. BCRLF cooperative agreement recipients must use EPA funds provided through BCRLF cooperative agreement for specified brownfields-related cleanup activities.

Date of Government Version: 10/01/2008
Date Data Arrived at EDR: 11/14/2008
Date Made Active in Reports: 12/23/2008
Number of Days to Update: 39

Source: Environmental Protection Agency
Telephone: 202-566-2777
Last EDR Contact: 02/10/2009
Next Scheduled EDR Contact: 04/13/2009
Data Release Frequency: Semi-Annually

Local Lists of Landfill / Solid Waste Disposal Sites

DEBRIS REGION 9: Torres Martinez Reservation Illegal Dump Site Locations

A listing of illegal dump sites location on the Torres Martinez Indian Reservation located in eastern Riverside County and northern Imperial County, California.

Date of Government Version: 03/25/2008
Date Data Arrived at EDR: 04/17/2008
Date Made Active in Reports: 05/15/2008
Number of Days to Update: 28

Source: EPA, Region 9
Telephone: 415-972-3336
Last EDR Contact: 12/22/2008
Next Scheduled EDR Contact: 03/23/2009
Data Release Frequency: Varies

ODI: Open Dump Inventory

An open dump is defined as a disposal facility that does not comply with one or more of the Part 257 or Part 258 Subtitle D Criteria.

GOVERNMENT RECORDS SEARCHED / DATA CURRENCY TRACKING

Date of Government Version: 06/30/1985
Date Data Arrived at EDR: 08/09/2004
Date Made Active in Reports: 09/17/2004
Number of Days to Update: 39

Source: Environmental Protection Agency
Telephone: 800-424-9346
Last EDR Contact: 06/09/2004
Next Scheduled EDR Contact: N/A
Data Release Frequency: No Update Planned

HIST LF ALI: Abandoned Landfill Inventory

The report provides facility information recorded in the Pennsylvania Department of Environmental Protection ALI database. Some of this information has been abstracted from old records and may not accurately reflect the current conditions and status at these facilities

Date of Government Version: 01/04/2005
Date Data Arrived at EDR: 01/04/2005
Date Made Active in Reports: 02/04/2005
Number of Days to Update: 31

Source: Department of Environmental Protection
Telephone: 717-787-7564
Last EDR Contact: 12/15/2008
Next Scheduled EDR Contact: 03/16/2009
Data Release Frequency: Varies

HIST LF INVENTORY: Facility Inventory

A listing of solid waste facilities. This listing is no longer updated or maintained by the Department of Environmental Protection. At the time the listing was available, the DEP's name was the Department of Environmental Resources.

Date of Government Version: 06/02/1999
Date Data Arrived at EDR: 07/12/2005
Date Made Active in Reports: 08/11/2005
Number of Days to Update: 30

Source: Department of Environmental Protection
Telephone: 717-787-7381
Last EDR Contact: 09/19/2005
Next Scheduled EDR Contact: 12/19/2005
Data Release Frequency: No Update Planned

HIST LF INACTIVE: Inactive Facilities List

A listing of inactive non-hazardous facilities (10000 & 300000 series). This listing is no longer updated or maintained by the Department of Environmental Protection. At the time the listing was available, the DEP's name was the Department of Environmental Resources.

Date of Government Version: 12/20/1994
Date Data Arrived at EDR: 07/12/2005
Date Made Active in Reports: 08/11/2005
Number of Days to Update: 30

Source: Department of Environmental Protection
Telephone: 717-787-7381
Last EDR Contact: 06/21/2005
Next Scheduled EDR Contact: 12/19/2005
Data Release Frequency: No Update Planned

INDIAN ODI: Report on the Status of Open Dumps on Indian Lands

Location of open dumps on Indian land.

Date of Government Version: 12/31/1998
Date Data Arrived at EDR: 12/03/2007
Date Made Active in Reports: 01/24/2008
Number of Days to Update: 52

Source: Environmental Protection Agency
Telephone: 703-308-8245
Last EDR Contact: 11/24/2008
Next Scheduled EDR Contact: 02/23/2009
Data Release Frequency: Varies

Local Lists of Hazardous waste / Contaminated Sites

CDL: Clandestine Drug Labs

A listing of clandestine drug lab locations. The U.S. Department of Justice ("the Department") provides this web site as a public service. It contains addresses of some locations where law enforcement agencies reported they found chemicals or other items that indicated the presence of either clandestine drug laboratories or dumpsites. In most cases, the source of the entries is not the Department, and the Department has not verified the entry and does not guarantee its accuracy. Members of the public must verify the accuracy of all entries by, for example, contacting local law enforcement and local health departments.

Date of Government Version: 07/01/2008
Date Data Arrived at EDR: 10/31/2008
Date Made Active in Reports: 12/23/2008
Number of Days to Update: 53

Source: Drug Enforcement Administration
Telephone: 202-307-1000
Last EDR Contact: 10/31/2008
Next Scheduled EDR Contact: 03/23/2009
Data Release Frequency: Quarterly

GOVERNMENT RECORDS SEARCHED / DATA CURRENCY TRACKING

Local Lists of Registered Storage Tanks

ARCHIVE UST: Archived Underground Storage Tank Sites

The list includes tanks storing highly hazardous substances that were removed from the DEP's Storage Tank Information database because of the Department's policy on sensitive information. The list also may include tanks that are removed or permanently closed.

Date of Government Version: 09/02/2008	Source: Department of Environmental Protection
Date Data Arrived at EDR: 10/09/2008	Telephone: 717-772-5599
Date Made Active in Reports: 10/23/2008	Last EDR Contact: 01/09/2009
Number of Days to Update: 14	Next Scheduled EDR Contact: 04/06/2009
	Data Release Frequency: Varies

ARCHIVE AST: Archived Aboveground Storage Tank Sites

The list includes aboveground tanks with a capacity greater than 21,000 gallons that were removed from the DEP's Storage Tank Information database because of the Department's policy on sensitive information. The list also may include tanks that are removed or permanently closed.

Date of Government Version: 09/02/2008	Source: Department of Environmental Protection
Date Data Arrived at EDR: 10/09/2008	Telephone: 717-772-5599
Date Made Active in Reports: 10/23/2008	Last EDR Contact: 01/09/2009
Number of Days to Update: 14	Next Scheduled EDR Contact: 04/06/2009
	Data Release Frequency: Varies

Local Land Records

LIENS 2: CERCLA Lien Information

A Federal CERCLA ('Superfund') lien can exist by operation of law at any site or property at which EPA has spent Superfund monies. These monies are spent to investigate and address releases and threatened releases of contamination. CERCLIS provides information as to the identity of these sites and properties.

Date of Government Version: 08/19/2008	Source: Environmental Protection Agency
Date Data Arrived at EDR: 08/29/2008	Telephone: 202-564-6023
Date Made Active in Reports: 09/09/2008	Last EDR Contact: 11/17/2008
Number of Days to Update: 11	Next Scheduled EDR Contact: 02/16/2009
	Data Release Frequency: Varies

LUCIS: Land Use Control Information System

LUCIS contains records of land use control information pertaining to the former Navy Base Realignment and Closure properties.

Date of Government Version: 12/09/2005	Source: Department of the Navy
Date Data Arrived at EDR: 12/11/2006	Telephone: 843-820-7326
Date Made Active in Reports: 01/11/2007	Last EDR Contact: 12/08/2008
Number of Days to Update: 31	Next Scheduled EDR Contact: 03/09/2009
	Data Release Frequency: Varies

ACT 2-DEED: Act 2-Deed Acknowledgment Sites

This listing pertains to sites where the Department has approved a cleanup requiring a deed acknowledgment under Act 2. This list includes sites remediated to a non-residential Statewide health standard (Section 303(g)); all sites demonstrating attainment of a Site-specific standard (Section 304(m)); and sites being remediated as a special industrial area (Section 305(g)). Persons who remediated a site to a standard that requires a deed acknowledgment shall comply with the requirements of the Solid Waste Management Act or the Hazardous Sites Cleanup Act, as referenced in Act 2. These statutes require a property description section in the deed concerning the hazardous substance disposal on the site. The location of disposed hazardous substances and a description of the type of hazardous substances disposed on the site shall be included in the deed acknowledgment. A deed acknowledgment is required at the time of conveyance of the property.

Date of Government Version: 08/25/2008	Source: Department of Environmental Protection
Date Data Arrived at EDR: 08/25/2008	Telephone: 717-783-9470
Date Made Active in Reports: 09/04/2008	Last EDR Contact: 02/09/2009
Number of Days to Update: 10	Next Scheduled EDR Contact: 05/11/2009
	Data Release Frequency: Varies

GOVERNMENT RECORDS SEARCHED / DATA CURRENCY TRACKING

Records of Emergency Release Reports

HMIRS: Hazardous Materials Information Reporting System

Hazardous Materials Incident Report System. HMIRS contains hazardous material spill incidents reported to DOT.

Date of Government Version: 09/30/2008
Date Data Arrived at EDR: 10/16/2008
Date Made Active in Reports: 11/19/2008
Number of Days to Update: 34

Source: U.S. Department of Transportation
Telephone: 202-366-4555
Last EDR Contact: 01/30/2009
Next Scheduled EDR Contact: 04/13/2009
Data Release Frequency: Annually

SPILLS: State spills

A listing of hazardous material incidents.

Date of Government Version: 11/04/2008
Date Data Arrived at EDR: 11/26/2008
Date Made Active in Reports: 12/12/2008
Number of Days to Update: 16

Source: DEP, Emergency Response
Telephone: 717-787-5715
Last EDR Contact: 02/02/2009
Next Scheduled EDR Contact: 05/04/2009
Data Release Frequency: Varies

Other Ascertainable Records

RCRA-NonGen: RCRA - Non Generators

RCRAInfo is EPA's comprehensive information system, providing access to data supporting the Resource Conservation and Recovery Act (RCRA) of 1976 and the Hazardous and Solid Waste Amendments (HSWA) of 1984. The database includes selective information on sites which generate, transport, store, treat and/or dispose of hazardous waste as defined by the Resource Conservation and Recovery Act (RCRA). Non-Generators do not presently generate hazardous waste.

Date of Government Version: 09/10/2008
Date Data Arrived at EDR: 09/23/2008
Date Made Active in Reports: 10/16/2008
Number of Days to Update: 23

Source: Environmental Protection Agency
Telephone: 800-438-2474
Last EDR Contact: 02/06/2009
Next Scheduled EDR Contact: 02/16/2009
Data Release Frequency: Varies

DOT OPS: Incident and Accident Data

Department of Transportation, Office of Pipeline Safety Incident and Accident data.

Date of Government Version: 05/14/2008
Date Data Arrived at EDR: 05/28/2008
Date Made Active in Reports: 08/08/2008
Number of Days to Update: 72

Source: Department of Transportation, Office of Pipeline Safety
Telephone: 202-366-4595
Last EDR Contact: 11/26/2008
Next Scheduled EDR Contact: 02/23/2009
Data Release Frequency: Varies

DOD: Department of Defense Sites

This data set consists of federally owned or administered lands, administered by the Department of Defense, that have any area equal to or greater than 640 acres of the United States, Puerto Rico, and the U.S. Virgin Islands.

Date of Government Version: 12/31/2005
Date Data Arrived at EDR: 11/10/2006
Date Made Active in Reports: 01/11/2007
Number of Days to Update: 62

Source: USGS
Telephone: 703-692-8801
Last EDR Contact: 02/06/2009
Next Scheduled EDR Contact: 05/04/2009
Data Release Frequency: Semi-Annually

FUDS: Formerly Used Defense Sites

The listing includes locations of Formerly Used Defense Sites properties where the US Army Corps of Engineers is actively working or will take necessary cleanup actions.

Date of Government Version: 12/31/2007
Date Data Arrived at EDR: 09/05/2008
Date Made Active in Reports: 09/23/2008
Number of Days to Update: 18

Source: U.S. Army Corps of Engineers
Telephone: 202-528-4285
Last EDR Contact: 12/29/2008
Next Scheduled EDR Contact: 03/30/2009
Data Release Frequency: Varies

GOVERNMENT RECORDS SEARCHED / DATA CURRENCY TRACKING

CONSENT: Superfund (CERCLA) Consent Decrees

Major legal settlements that establish responsibility and standards for cleanup at NPL (Superfund) sites. Released periodically by United States District Courts after settlement by parties to litigation matters.

Date of Government Version: 09/15/2008	Source: Department of Justice, Consent Decree Library
Date Data Arrived at EDR: 10/22/2008	Telephone: Varies
Date Made Active in Reports: 12/23/2008	Last EDR Contact: 01/19/2009
Number of Days to Update: 62	Next Scheduled EDR Contact: 04/19/2009
	Data Release Frequency: Varies

ROD: Records Of Decision

Record of Decision. ROD documents mandate a permanent remedy at an NPL (Superfund) site containing technical and health information to aid in the cleanup.

Date of Government Version: 10/21/2008	Source: EPA
Date Data Arrived at EDR: 10/29/2008	Telephone: 703-416-0223
Date Made Active in Reports: 12/23/2008	Last EDR Contact: 12/29/2008
Number of Days to Update: 55	Next Scheduled EDR Contact: 03/30/2009
	Data Release Frequency: Annually

UMTRA: Uranium Mill Tailings Sites

Uranium ore was mined by private companies for federal government use in national defense programs. When the mills shut down, large piles of the sand-like material (mill tailings) remain after uranium has been extracted from the ore. Levels of human exposure to radioactive materials from the piles are low; however, in some cases tailings were used as construction materials before the potential health hazards of the tailings were recognized.

Date of Government Version: 07/13/2007	Source: Department of Energy
Date Data Arrived at EDR: 12/03/2007	Telephone: 505-845-0011
Date Made Active in Reports: 01/24/2008	Last EDR Contact: 12/17/2008
Number of Days to Update: 52	Next Scheduled EDR Contact: 03/16/2009
	Data Release Frequency: Varies

MINES: Mines Master Index File

Contains all mine identification numbers issued for mines active or opened since 1971. The data also includes violation information.

Date of Government Version: 08/07/2008	Source: Department of Labor, Mine Safety and Health Administration
Date Data Arrived at EDR: 09/23/2008	Telephone: 303-231-5959
Date Made Active in Reports: 10/16/2008	Last EDR Contact: 12/23/2008
Number of Days to Update: 23	Next Scheduled EDR Contact: 03/23/2009
	Data Release Frequency: Semi-Annually

TRIS: Toxic Chemical Release Inventory System

Toxic Release Inventory System. TRIS identifies facilities which release toxic chemicals to the air, water and land in reportable quantities under SARA Title III Section 313.

Date of Government Version: 12/31/2006	Source: EPA
Date Data Arrived at EDR: 02/29/2008	Telephone: 202-566-0250
Date Made Active in Reports: 04/18/2008	Last EDR Contact: 09/19/2008
Number of Days to Update: 49	Next Scheduled EDR Contact: 12/15/2008
	Data Release Frequency: Annually

TSCA: Toxic Substances Control Act

Toxic Substances Control Act. TSCA identifies manufacturers and importers of chemical substances included on the TSCA Chemical Substance Inventory list. It includes data on the production volume of these substances by plant site.

Date of Government Version: 12/31/2002	Source: EPA
Date Data Arrived at EDR: 04/14/2006	Telephone: 202-260-5521
Date Made Active in Reports: 05/30/2006	Last EDR Contact: 01/12/2009
Number of Days to Update: 46	Next Scheduled EDR Contact: 04/13/2009
	Data Release Frequency: Every 4 Years

GOVERNMENT RECORDS SEARCHED / DATA CURRENCY TRACKING

FTTS: FIFRA/ TSCA Tracking System - FIFRA (Federal Insecticide, Fungicide, & Rodenticide Act)/TSCA (Toxic Substances Control Act)
FTTS tracks administrative cases and pesticide enforcement actions and compliance activities related to FIFRA, TSCA and EPCRA (Emergency Planning and Community Right-to-Know Act). To maintain currency, EDR contacts the Agency on a quarterly basis.

Date of Government Version: 10/08/2008
Date Data Arrived at EDR: 10/17/2008
Date Made Active in Reports: 12/08/2008
Number of Days to Update: 52

Source: EPA/Office of Prevention, Pesticides and Toxic Substances
Telephone: 202-566-1667
Last EDR Contact: 12/15/2008
Next Scheduled EDR Contact: 03/16/2009
Data Release Frequency: Quarterly

FTTS INSP: FIFRA/ TSCA Tracking System - FIFRA (Federal Insecticide, Fungicide, & Rodenticide Act)/TSCA (Toxic Substances Control Act)
A listing of FIFRA/TSCA Tracking System (FTTS) inspections and enforcements.

Date of Government Version: 10/08/2008
Date Data Arrived at EDR: 10/17/2008
Date Made Active in Reports: 12/08/2008
Number of Days to Update: 52

Source: EPA
Telephone: 202-566-1667
Last EDR Contact: 12/15/2008
Next Scheduled EDR Contact: 03/16/2009
Data Release Frequency: Quarterly

HIST FTTS: FIFRA/TSCA Tracking System Administrative Case Listing

A complete administrative case listing from the FIFRA/TSCA Tracking System (FTTS) for all ten EPA regions. The information was obtained from the National Compliance Database (NCDB). NCDB supports the implementation of FIFRA (Federal Insecticide, Fungicide, and Rodenticide Act) and TSCA (Toxic Substances Control Act). Some EPA regions are now closing out records. Because of that, and the fact that some EPA regions are not providing EPA Headquarters with updated records, it was decided to create a HIST FTTS database. It included records that may not be included in the newer FTTS database updates. This database is no longer updated.

Date of Government Version: 10/19/2006
Date Data Arrived at EDR: 03/01/2007
Date Made Active in Reports: 04/10/2007
Number of Days to Update: 40

Source: Environmental Protection Agency
Telephone: 202-564-2501
Last EDR Contact: 12/17/2007
Next Scheduled EDR Contact: 03/17/2008
Data Release Frequency: No Update Planned

HIST FTTS INSP: FIFRA/TSCA Tracking System Inspection & Enforcement Case Listing

A complete inspection and enforcement case listing from the FIFRA/TSCA Tracking System (FTTS) for all ten EPA regions. The information was obtained from the National Compliance Database (NCDB). NCDB supports the implementation of FIFRA (Federal Insecticide, Fungicide, and Rodenticide Act) and TSCA (Toxic Substances Control Act). Some EPA regions are now closing out records. Because of that, and the fact that some EPA regions are not providing EPA Headquarters with updated records, it was decided to create a HIST FTTS database. It included records that may not be included in the newer FTTS database updates. This database is no longer updated.

Date of Government Version: 10/19/2006
Date Data Arrived at EDR: 03/01/2007
Date Made Active in Reports: 04/10/2007
Number of Days to Update: 40

Source: Environmental Protection Agency
Telephone: 202-564-2501
Last EDR Contact: 12/17/2008
Next Scheduled EDR Contact: 03/17/2008
Data Release Frequency: No Update Planned

SSTS: Section 7 Tracking Systems

Section 7 of the Federal Insecticide, Fungicide and Rodenticide Act, as amended (92 Stat. 829) requires all registered pesticide-producing establishments to submit a report to the Environmental Protection Agency by March 1st each year. Each establishment must report the types and amounts of pesticides, active ingredients and devices being produced, and those having been produced and sold or distributed in the past year.

Date of Government Version: 12/31/2006
Date Data Arrived at EDR: 03/14/2008
Date Made Active in Reports: 04/18/2008
Number of Days to Update: 35

Source: EPA
Telephone: 202-564-4203
Last EDR Contact: 12/04/2008
Next Scheduled EDR Contact: 01/12/2009
Data Release Frequency: Annually

GOVERNMENT RECORDS SEARCHED / DATA CURRENCY TRACKING

ICIS: Integrated Compliance Information System

The Integrated Compliance Information System (ICIS) supports the information needs of the national enforcement and compliance program as well as the unique needs of the National Pollutant Discharge Elimination System (NPDES) program.

Date of Government Version: 07/31/2008
Date Data Arrived at EDR: 08/13/2008
Date Made Active in Reports: 09/09/2008
Number of Days to Update: 27

Source: Environmental Protection Agency
Telephone: 202-564-5088
Last EDR Contact: 01/12/2009
Next Scheduled EDR Contact: 04/13/2009
Data Release Frequency: Quarterly

PADS: PCB Activity Database System

PCB Activity Database. PADS identifies generators, transporters, commercial storers and/or brokers and disposers of PCB's who are required to notify the EPA of such activities.

Date of Government Version: 12/04/2007
Date Data Arrived at EDR: 02/07/2008
Date Made Active in Reports: 03/17/2008
Number of Days to Update: 39

Source: EPA
Telephone: 202-566-0500
Last EDR Contact: 02/02/2009
Next Scheduled EDR Contact: 05/04/2009
Data Release Frequency: Annually

MLTS: Material Licensing Tracking System

MLTS is maintained by the Nuclear Regulatory Commission and contains a list of approximately 8,100 sites which possess or use radioactive materials and which are subject to NRC licensing requirements. To maintain currency, EDR contacts the Agency on a quarterly basis.

Date of Government Version: 10/03/2008
Date Data Arrived at EDR: 10/15/2008
Date Made Active in Reports: 11/19/2008
Number of Days to Update: 35

Source: Nuclear Regulatory Commission
Telephone: 301-415-7169
Last EDR Contact: 12/29/2008
Next Scheduled EDR Contact: 03/30/2009
Data Release Frequency: Quarterly

RADINFO: Radiation Information Database

The Radiation Information Database (RADINFO) contains information about facilities that are regulated by U.S. Environmental Protection Agency (EPA) regulations for radiation and radioactivity.

Date of Government Version: 10/28/2008
Date Data Arrived at EDR: 10/29/2008
Date Made Active in Reports: 12/08/2008
Number of Days to Update: 40

Source: Environmental Protection Agency
Telephone: 202-343-9775
Last EDR Contact: 01/30/2009
Next Scheduled EDR Contact: 04/27/2009
Data Release Frequency: Quarterly

FINDS: Facility Index System/Facility Registry System

Facility Index System. FINDS contains both facility information and 'pointers' to other sources that contain more detail. EDR includes the following FINDS databases in this report: PCS (Permit Compliance System), AIRS (Aerometric Information Retrieval System), DOCKET (Enforcement Docket used to manage and track information on civil judicial enforcement cases for all environmental statutes), FURS (Federal Underground Injection Control), C-DOCKET (Criminal Docket System used to track criminal enforcement actions for all environmental statutes), FFIS (Federal Facilities Information System), STATE (State Environmental Laws and Statutes), and PADS (PCB Activity Data System).

Date of Government Version: 10/30/2008
Date Data Arrived at EDR: 10/31/2008
Date Made Active in Reports: 12/23/2008
Number of Days to Update: 53

Source: EPA
Telephone: (215) 814-5000
Last EDR Contact: 12/29/2008
Next Scheduled EDR Contact: 03/30/2009
Data Release Frequency: Quarterly

RAATS: RCRA Administrative Action Tracking System

RCRA Administration Action Tracking System. RAATS contains records based on enforcement actions issued under RCRA pertaining to major violators and includes administrative and civil actions brought by the EPA. For administration actions after September 30, 1995, data entry in the RAATS database was discontinued. EPA will retain a copy of the database for historical records. It was necessary to terminate RAATS because a decrease in agency resources made it impossible to continue to update the information contained in the database.

GOVERNMENT RECORDS SEARCHED / DATA CURRENCY TRACKING

Date of Government Version: 04/17/1995
Date Data Arrived at EDR: 07/03/1995
Date Made Active in Reports: 08/07/1995
Number of Days to Update: 35

Source: EPA
Telephone: 202-564-4104
Last EDR Contact: 06/02/2008
Next Scheduled EDR Contact: 09/01/2008
Data Release Frequency: No Update Planned

BRS: Biennial Reporting System

The Biennial Reporting System is a national system administered by the EPA that collects data on the generation and management of hazardous waste. BRS captures detailed data from two groups: Large Quantity Generators (LQG) and Treatment, Storage, and Disposal Facilities.

Date of Government Version: 12/31/2005
Date Data Arrived at EDR: 03/06/2007
Date Made Active in Reports: 04/13/2007
Number of Days to Update: 38

Source: EPA/NTIS
Telephone: 800-424-9346
Last EDR Contact: 12/09/2008
Next Scheduled EDR Contact: 03/09/2009
Data Release Frequency: Biennially

PA MANIFEST: Manifest Information

Hazardous waste manifest information.

Date of Government Version: 12/31/2007
Date Data Arrived at EDR: 09/11/2008
Date Made Active in Reports: 10/02/2008
Number of Days to Update: 21

Source: Department of Environmental Protection
Telephone: N/A
Last EDR Contact: 12/08/2008
Next Scheduled EDR Contact: 03/09/2009
Data Release Frequency: Annually

DRYCLEANERS: Drycleaner Facility Locations

A listing of drycleaner facility locations.

Date of Government Version: 10/21/2008
Date Data Arrived at EDR: 10/22/2008
Date Made Active in Reports: 12/12/2008
Number of Days to Update: 51

Source: Department of Environmental Protection
Telephone: 717-787-9702
Last EDR Contact: 01/12/2009
Next Scheduled EDR Contact: 04/13/2009
Data Release Frequency: Varies

AIRS: Permit and Emissions Inventory Data

Permit and emissions inventory data.

Date of Government Version: 12/31/2006
Date Data Arrived at EDR: 01/25/2007
Date Made Active in Reports: 03/12/2007
Number of Days to Update: 46

Source: Department of Environmental Protection
Telephone: 717-787-9702
Last EDR Contact: 01/19/2009
Next Scheduled EDR Contact: 04/19/2009
Data Release Frequency: Annually

INDIAN RESERV: Indian Reservations

This map layer portrays Indian administered lands of the United States that have any area equal to or greater than 640 acres.

Date of Government Version: 12/31/2005
Date Data Arrived at EDR: 12/08/2006
Date Made Active in Reports: 01/11/2007
Number of Days to Update: 34

Source: USGS
Telephone: 202-208-3710
Last EDR Contact: 02/06/2009
Next Scheduled EDR Contact: 05/04/2009
Data Release Frequency: Semi-Annually

SCRD DRYCLEANERS: State Coalition for Remediation of Drycleaners Listing

The State Coalition for Remediation of Drycleaners was established in 1998, with support from the U.S. EPA Office of Superfund Remediation and Technology Innovation. It is comprised of representatives of states with established drycleaner remediation programs. Currently the member states are Alabama, Connecticut, Florida, Illinois, Kansas, Minnesota, Missouri, North Carolina, Oregon, South Carolina, Tennessee, Texas, and Wisconsin.

GOVERNMENT RECORDS SEARCHED / DATA CURRENCY TRACKING

Date of Government Version: 09/08/2008
Date Data Arrived at EDR: 09/10/2008
Date Made Active in Reports: 09/23/2008
Number of Days to Update: 13

Source: Environmental Protection Agency
Telephone: 615-532-8599
Last EDR Contact: 02/09/2009
Next Scheduled EDR Contact: 05/11/2009
Data Release Frequency: Varies

PWS: Public Water System Data

This Safe Drinking Water Information System (SDWIS) file contains public water systems name and address, population served and the primary source of water

Date of Government Version: 02/24/2000
Date Data Arrived at EDR: 04/27/2005
Date Made Active in Reports: N/A
Number of Days to Update: 0

Source: EPA
Telephone: N/A
Last EDR Contact: 12/29/2008
Next Scheduled EDR Contact: 03/30/2009
Data Release Frequency: N/A

FEDLAND: Federal and Indian Lands

Federally and Indian administrated lands of the United States. Lands included are administrated by: Army Corps of Engineers, Bureau of Reclamation, National Wild and Scenic River, National Wildlife Refuge, Public Domain Land, Wilderness, Wilderness Study Area, Wildlife Management Area, Bureau of Indian Affairs, Bureau of Land Management, Department of Justice, Forest Service, Fish and Wildlife Service, National Park Service.

Date of Government Version: 12/31/2005
Date Data Arrived at EDR: 02/06/2006
Date Made Active in Reports: 01/11/2007
Number of Days to Update: 339

Source: U.S. Geological Survey
Telephone: 888-275-8747
Last EDR Contact: 02/06/2009
Next Scheduled EDR Contact: 05/04/2009
Data Release Frequency: N/A

PRP: Potentially Responsible Parties

A listing of verified Potentially Responsible Parties

Date of Government Version: 07/09/2008
Date Data Arrived at EDR: 09/30/2008
Date Made Active in Reports: 10/07/2008
Number of Days to Update: 7

Source: EPA
Telephone: 202-564-6064
Last EDR Contact: 12/29/2008
Next Scheduled EDR Contact: 03/30/2009
Data Release Frequency: Quarterly

EDR PROPRIETARY RECORDS

EDR Proprietary Records

Manufactured Gas Plants: EDR Proprietary Manufactured Gas Plants

The EDR Proprietary Manufactured Gas Plant Database includes records of coal gas plants (manufactured gas plants) compiled by EDR's researchers. Manufactured gas sites were used in the United States from the 1800's to 1950's to produce a gas that could be distributed and used as fuel. These plants used whale oil, rosin, coal, or a mixture of coal, oil, and water that also produced a significant amount of waste. Many of the byproducts of the gas production, such as coal tar (oily waste containing volatile and non-volatile chemicals), sludges, oils and other compounds are potentially hazardous to human health and the environment. The byproduct from this process was frequently disposed of directly at the plant site and can remain or spread slowly, serving as a continuous source of soil and groundwater contamination.

Date of Government Version: N/A
Date Data Arrived at EDR: N/A
Date Made Active in Reports: N/A
Number of Days to Update: N/A

Source: EDR, Inc.
Telephone: N/A
Last EDR Contact: N/A
Next Scheduled EDR Contact: N/A
Data Release Frequency: No Update Planned

GOVERNMENT RECORDS SEARCHED / DATA CURRENCY TRACKING

OTHER DATABASE(S)

Depending on the geographic area covered by this report, the data provided in these specialty databases may or may not be complete. For example, the existence of wetlands information data in a specific report does not mean that all wetlands in the area covered by the report are included. Moreover, the absence of any reported wetlands information does not necessarily mean that wetlands do not exist in the area covered by the report.

CT MANIFEST: Hazardous Waste Manifest Data

Facility and manifest data. Manifest is a document that lists and tracks hazardous waste from the generator through transporters to a tsd facility.

Date of Government Version: 12/31/2005
Date Data Arrived at EDR: 06/15/2007
Date Made Active in Reports: 08/20/2007
Number of Days to Update: 66

Source: Department of Environmental Protection
Telephone: 860-424-3375
Last EDR Contact: 12/11/2008
Next Scheduled EDR Contact: 03/09/2009
Data Release Frequency: Annually

NJ MANIFEST: Manifest Information

Hazardous waste manifest information.

Date of Government Version: 09/30/2007
Date Data Arrived at EDR: 12/04/2007
Date Made Active in Reports: 12/31/2007
Number of Days to Update: 27

Source: Department of Environmental Protection
Telephone: N/A
Last EDR Contact: 02/03/2009
Next Scheduled EDR Contact: 05/04/2009
Data Release Frequency: Annually

NY MANIFEST: Facility and Manifest Data

Manifest is a document that lists and tracks hazardous waste from the generator through transporters to a TSD facility.

Date of Government Version: 10/21/2008
Date Data Arrived at EDR: 11/26/2008
Date Made Active in Reports: 12/11/2008
Number of Days to Update: 15

Source: Department of Environmental Conservation
Telephone: 518-402-8651
Last EDR Contact: 11/26/2008
Next Scheduled EDR Contact: 02/23/2009
Data Release Frequency: Annually

RI MANIFEST: Manifest information

Hazardous waste manifest information

Date of Government Version: 10/07/2008
Date Data Arrived at EDR: 10/10/2008
Date Made Active in Reports: 10/28/2008
Number of Days to Update: 18

Source: Department of Environmental Management
Telephone: 401-222-2797
Last EDR Contact: 12/15/2008
Next Scheduled EDR Contact: 03/16/2009
Data Release Frequency: Annually

VT MANIFEST: Hazardous Waste Manifest Data

Hazardous waste manifest information.

Date of Government Version: 03/17/2008
Date Data Arrived at EDR: 03/26/2008
Date Made Active in Reports: 04/09/2008
Number of Days to Update: 14

Source: Department of Environmental Conservation
Telephone: 802-241-3443
Last EDR Contact: 02/09/2009
Next Scheduled EDR Contact: 05/11/2009
Data Release Frequency: Annually

WI MANIFEST: Manifest Information

Hazardous waste manifest information.

Date of Government Version: 12/31/2007
Date Data Arrived at EDR: 08/22/2008
Date Made Active in Reports: 09/08/2008
Number of Days to Update: 17

Source: Department of Natural Resources
Telephone: N/A
Last EDR Contact: 01/05/2009
Next Scheduled EDR Contact: 04/06/2009
Data Release Frequency: Annually

GOVERNMENT RECORDS SEARCHED / DATA CURRENCY TRACKING

Oil/Gas Pipelines: This data was obtained by EDR from the USGS in 1994. It is referred to by USGS as GeoData Digital Line Graphs from 1:100,000-Scale Maps. It was extracted from the transportation category including some oil, but primarily gas pipelines.

Electric Power Transmission Line Data

Source: PennWell Corporation

Telephone: (800) 823-6277

This map includes information copyrighted by PennWell Corporation. This information is provided on a best effort basis and PennWell Corporation does not guarantee its accuracy nor warrant its fitness for any particular purpose. Such information has been reprinted with the permission of PennWell.

Sensitive Receptors: There are individuals deemed sensitive receptors due to their fragile immune systems and special sensitivity to environmental discharges. These sensitive receptors typically include the elderly, the sick, and children. While the location of all sensitive receptors cannot be determined, EDR indicates those buildings and facilities - schools, daycares, hospitals, medical centers, and nursing homes - where individuals who are sensitive receptors are likely to be located.

AHA Hospitals:

Source: American Hospital Association, Inc.

Telephone: 312-280-5991

The database includes a listing of hospitals based on the American Hospital Association's annual survey of hospitals.

Medical Centers: Provider of Services Listing

Source: Centers for Medicare & Medicaid Services

Telephone: 410-786-3000

A listing of hospitals with Medicare provider number, produced by Centers of Medicare & Medicaid Services, a federal agency within the U.S. Department of Health and Human Services.

Nursing Homes

Source: National Institutes of Health

Telephone: 301-594-6248

Information on Medicare and Medicaid certified nursing homes in the United States.

Public Schools

Source: National Center for Education Statistics

Telephone: 202-502-7300

The National Center for Education Statistics' primary database on elementary and secondary public education in the United States. It is a comprehensive, annual, national statistical database of all public elementary and secondary schools and school districts, which contains data that are comparable across all states.

Private Schools

Source: National Center for Education Statistics

Telephone: 202-502-7300

The National Center for Education Statistics' primary database on private school locations in the United States.

Daycare Centers: Child Care Facility List

Source: Department of Public Welfare

Telephone: 717-783-3856

Flood Zone Data: This data, available in select counties across the country, was obtained by EDR in 1999 from the Federal Emergency Management Agency (FEMA). Data depicts 100-year and 500-year flood zones as defined by FEMA.

NWI: National Wetlands Inventory. This data, available in select counties across the country, was obtained by EDR in 2002 and 2005 from the U.S. Fish and Wildlife Service.

Scanned Digital USGS 7.5' Topographic Map (DRG)

Source: United States Geologic Survey

A digital raster graphic (DRG) is a scanned image of a U.S. Geological Survey topographic map. The map images are made by scanning published paper maps on high-resolution scanners. The raster image is georeferenced and fit to the Universal Transverse Mercator (UTM) projection.

GOVERNMENT RECORDS SEARCHED / DATA CURRENCY TRACKING

STREET AND ADDRESS INFORMATION

© 2009 Tele Atlas North America, Inc. All rights reserved. This material is proprietary and the subject of copyright protection and other intellectual property rights owned by or licensed to Tele Atlas North America, Inc. The use of this material is subject to the terms of a license agreement. You will be held liable for any unauthorized copying or disclosure of this material.

GEOCHECK[®] - PHYSICAL SETTING SOURCE ADDENDUM

TARGET PROPERTY ADDRESS

SCHELLSBURG LIBERTY TOWERS SITE
200 WEST RIDGE ROAD
SCHELLSBURG, PA 15559

TARGET PROPERTY COORDINATES

Latitude (North):	40.05170 - 40° 3' 6.1"
Longitude (West):	78.6582 - 78° 39' 29.5"
Universal Transverse Mercator:	Zone 17
UTM X (Meters):	699759.4
UTM Y (Meters):	4435913.0
Elevation:	1508 ft. above sea level

USGS TOPOGRAPHIC MAP

Target Property Map:	40078-A6 SCHELLSBURG, PA
Most Recent Revision:	1984

EDR's GeoCheck Physical Setting Source Addendum is provided to assist the environmental professional in forming an opinion about the impact of potential contaminant migration.

Assessment of the impact of contaminant migration generally has two principle investigative components:

1. Groundwater flow direction, and
2. Groundwater flow velocity.

Groundwater flow direction may be impacted by surface topography, hydrology, hydrogeology, characteristics of the soil, and nearby wells. Groundwater flow velocity is generally impacted by the nature of the geologic strata.

GEOCHECK® - PHYSICAL SETTING SOURCE SUMMARY

GROUNDWATER FLOW DIRECTION INFORMATION

Groundwater flow direction for a particular site is best determined by a qualified environmental professional using site-specific well data. If such data is not reasonably ascertainable, it may be necessary to rely on other sources of information, such as surface topographic information, hydrologic information, hydrogeologic data collected on nearby properties, and regional groundwater flow information (from deep aquifers).

TOPOGRAPHIC INFORMATION

Surface topography may be indicative of the direction of surficial groundwater flow. This information can be used to assist the environmental professional in forming an opinion about the impact of nearby contaminated properties or, should contamination exist on the target property, what downgradient sites might be impacted.

TARGET PROPERTY TOPOGRAPHY

General Topographic Gradient: General SSW

SURROUNDING TOPOGRAPHY: ELEVATION PROFILES

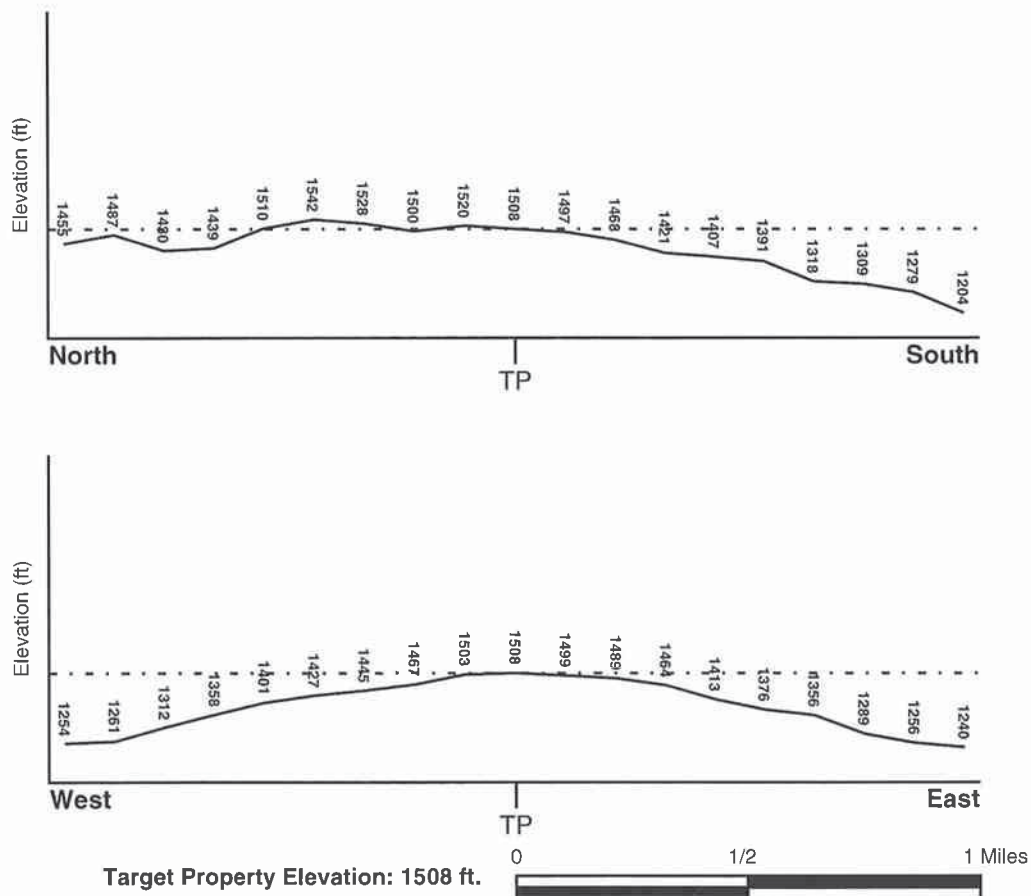

Source: Topography has been determined from the USGS 7.5' Digital Elevation Model and should be evaluated on a relative (not an absolute) basis. Relative elevation information between sites of close proximity should be field verified.

GEOCHECK® - PHYSICAL SETTING SOURCE SUMMARY

HYDROLOGIC INFORMATION

Surface water can act as a hydrologic barrier to groundwater flow. Such hydrologic information can be used to assist the environmental professional in forming an opinion about the impact of nearby contaminated properties or, should contamination exist on the target property, what downgradient sites might be impacted.

Refer to the Physical Setting Source Map following this summary for hydrologic information (major waterways and bodies of water).

FEMA FLOOD ZONE

<u>Target Property County</u> BEDFORD, PA	<u>FEMA Flood</u> <u>Electronic Data</u> YES - refer to the Overview Map and Detail Map
Flood Plain Panel at Target Property:	4213480020B
Additional Panels in search area:	4213480010B 4213480015B 4213480025B 00000000000

NATIONAL WETLAND INVENTORY

<u>NWI Quad at Target Property</u> SCHELLSBURG	<u>NWI Electronic</u> <u>Data Coverage</u> YES - refer to the Overview Map and Detail Map
---	---

HYDROGEOLOGIC INFORMATION

Hydrogeologic information obtained by installation of wells on a specific site can often be an indicator of groundwater flow direction in the immediate area. Such hydrogeologic information can be used to assist the environmental professional in forming an opinion about the impact of nearby contaminated properties or, should contamination exist on the target property, what downgradient sites might be impacted.

AQUIFLOW®

Search Radius: 1.000 Mile.

EDR has developed the AQUIFLOW Information System to provide data on the general direction of groundwater flow at specific points. EDR has reviewed reports submitted by environmental professionals to regulatory authorities at select sites and has extracted the date of the report, groundwater flow direction as determined hydrogeologically, and the depth to water table.

<u>MAP ID</u>	<u>LOCATION</u> <u>FROM TP</u>	<u>GENERAL DIRECTION</u> <u>GROUNDWATER FLOW</u>
Not Reported		

GEOCHECK® - PHYSICAL SETTING SOURCE SUMMARY

GROUNDWATER FLOW VELOCITY INFORMATION

Groundwater flow velocity information for a particular site is best determined by a qualified environmental professional using site specific geologic and soil strata data. If such data are not reasonably ascertainable, it may be necessary to rely on other sources of information, including geologic age identification, rock stratigraphic unit and soil characteristics data collected on nearby properties and regional soil information. In general, contaminant plumes move more quickly through sandy-gravelly types of soils than silty-clayey types of soils.

GEOLOGIC INFORMATION IN GENERAL AREA OF TARGET PROPERTY

Geologic information can be used by the environmental professional in forming an opinion about the relative speed at which contaminant migration may be occurring.

ROCK STRATIGRAPHIC UNIT

Era:	Paleozoic
System:	Devonian
Series:	Devonian
Code:	D (decoded above as Era, System & Series)

GEOLOGIC AGE IDENTIFICATION

Category: Stratified Sequence

Geologic Age and Rock Stratigraphic Unit Source: P.G. Schruben, R.E. Arndt and W.J. Bawiec, Geology of the Conterminous U.S. at 1:2,500,000 Scale - a digital representation of the 1974 P.B. King and H.M. Beikman Map, USGS Digital Data Series DDS - 11 (1994).

SSURGO SOIL MAP - 2420965.2s

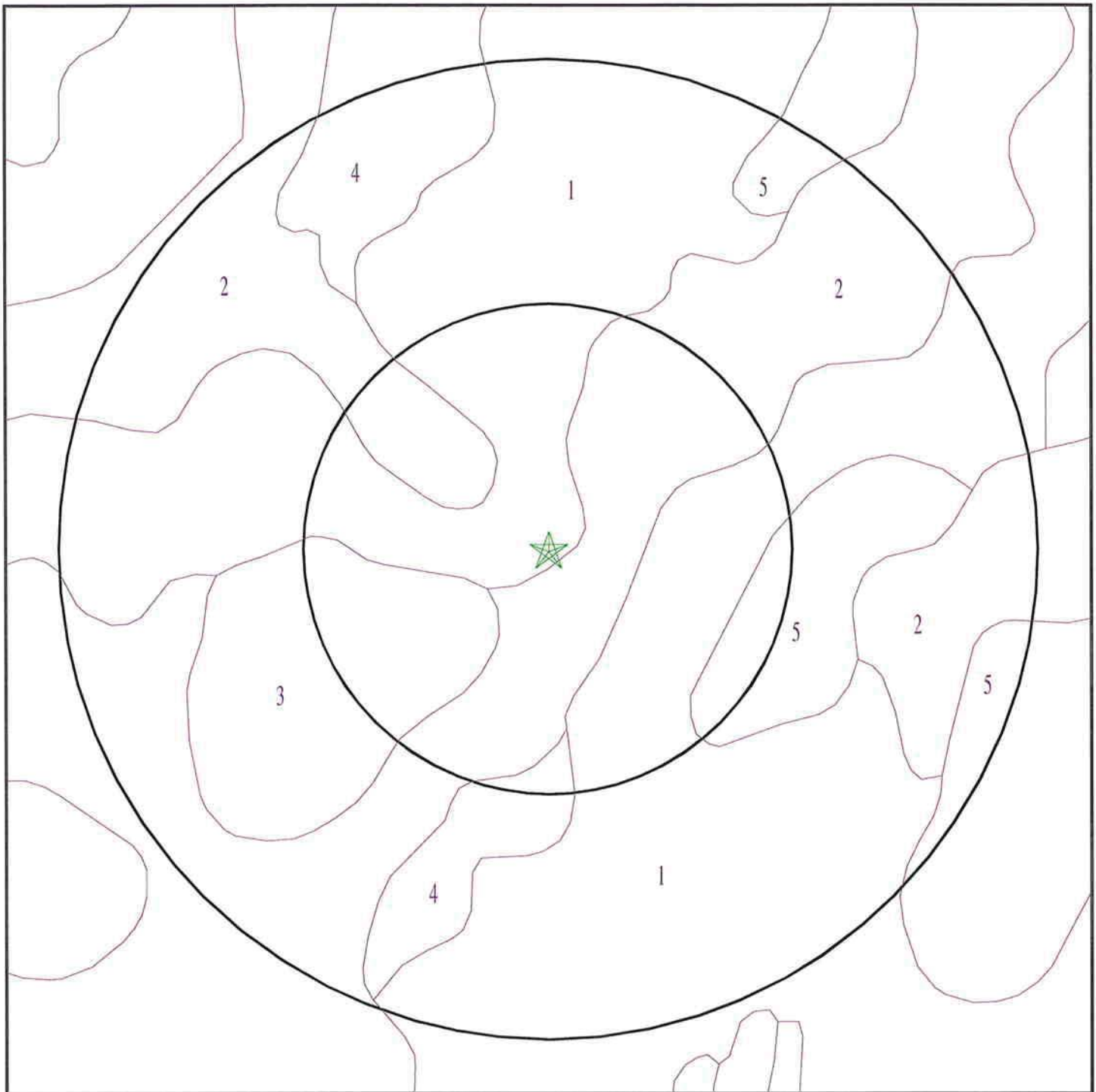

★ Target Property

SSURGO Soil

Water



SITE NAME: Schellsburg Liberty Towers Site
ADDRESS: 200 West Ridge Road
Schellsburg PA 15559
LAT/LONG: 40.0517 / 78.6582

CLIENT: Burgess Niple, Inc.
CONTACT: Anna Dougherty
INQUIRY #: 2420965.2s
DATE: February 13, 2009 11:35 am

GEOCHECK® - PHYSICAL SETTING SOURCE SUMMARY

DOMINANT SOIL COMPOSITION IN GENERAL AREA OF TARGET PROPERTY

The U.S. Department of Agriculture's (USDA) Soil Conservation Service (SCS) leads the National Cooperative Soil Survey (NCSS) and is responsible for collecting, storing, maintaining and distributing soil survey information for privately owned lands in the United States. A soil map in a soil survey is a representation of soil patterns in a landscape. The following information is based on Soil Conservation Service SSURGO data.

Soil Map ID: 1

Soil Component Name: Morrison

Soil Surface Texture: channery sandy loam

Hydrologic Group: Class B - Moderate infiltration rates. Deep and moderately deep, moderately well and well drained soils with moderately coarse textures.

Soil Drainage Class: Well drained

Hydric Status: Not hydric

Corrosion Potential - Uncoated Steel: Low

Depth to Bedrock Min: > 0 inches

Depth to Watertable Min: > 0 inches

Soil Layer Information							
Layer	Boundary		Soil Texture Class	Classification		Saturated hydraulic conductivity micro m/sec	Soil Reaction (pH)
	Upper	Lower		AASHTO Group	Unified Soil		
1	0 inches	9 inches	channery sandy loam	Silt-Clay Materials (more than 35 pct. passing No. 200), Silty Soils.	FINE-GRAINED SOILS, Silts and Clays (liquid limit less than 50%), silt.	Max: 42.34 Min: 4.23	Max: 6 Min: 3.6
2	50 inches	59 inches	gravelly sandy loam	Silt-Clay Materials (more than 35 pct. passing No. 200), Silty Soils.	FINE-GRAINED SOILS, Silts and Clays (liquid limit less than 50%), silt.	Max: 42.34 Min: 4.23	Max: 6 Min: 3.6
3	9 inches	50 inches	gravelly sandy clay loam	Silt-Clay Materials (more than 35 pct. passing No. 200), Silty Soils.	FINE-GRAINED SOILS, Silts and Clays (liquid limit less than 50%), silt.	Max: 42.34 Min: 4.23	Max: 6 Min: 3.6

GEOCHECK® - PHYSICAL SETTING SOURCE SUMMARY

Soil Map ID: 2

Soil Component Name: Morrison

Soil Surface Texture: channery sandy loam

Hydrologic Group: Class B - Moderate infiltration rates. Deep and moderately deep, moderately well and well drained soils with moderately coarse textures.

Soil Drainage Class: Well drained

Hydric Status: Not hydric

Corrosion Potential - Uncoated Steel: Low

Depth to Bedrock Min: > 0 inches

Depth to Watertable Min: > 0 inches

Soil Layer Information							
Layer	Boundary		Soil Texture Class	Classification		Saturated hydraulic conductivity micro m/sec	Soil Reaction (pH)
	Upper	Lower		AASHTO Group	Unified Soil		
1	0 inches	9 inches	channery sandy loam	Silt-Clay Materials (more than 35 pct. passing No. 200), Silty Soils.	COARSE-GRAINED SOILS, Sands, Sands with fines, Silty Sand.	Max: 42.34 Min: 4.23	Max: 6 Min: 5.1
2	9 inches	50 inches	gravelly sandy clay loam	Silt-Clay Materials (more than 35 pct. passing No. 200), Silty Soils.	COARSE-GRAINED SOILS, Sands, Sands with fines, Silty Sand.	Max: 42.34 Min: 4.23	Max: 6 Min: 5.1
3	50 inches	59 inches	gravelly sandy loam	Silt-Clay Materials (more than 35 pct. passing No. 200), Silty Soils.	COARSE-GRAINED SOILS, Sands, Sands with fines, Silty Sand.	Max: 42.34 Min: 4.23	Max: 6 Min: 5.1

Soil Map ID: 3

Soil Component Name: Elliber

Soil Surface Texture: very channery loam

Hydrologic Group: Class A - High infiltration rates. Soils are deep, well drained to excessively drained sands and gravels.

Soil Drainage Class: Well drained

GEOCHECK® - PHYSICAL SETTING SOURCE SUMMARY

Hydric Status: Not hydric

Corrosion Potential - Uncoated Steel: Low

Depth to Bedrock Min: > 0 inches

Depth to Watertable Min: > 0 inches

Soil Layer Information							
Layer	Boundary		Soil Texture Class	Classification		Saturated hydraulic conductivity micro m/sec	Soil Reaction (pH)
	Upper	Lower		AASHTO Group	Unified Soil		
1	0 inches	5 inches	very channery loam	Granular materials (35 pct. or less passing No. 200), Stone Fragments, Gravel and Sand.	COARSE-GRAINED SOILS, Sands, Sands with fines, Silty Sand.	Max: 42.34 Min: 4.23	Max: 5.5 Min: 3.6
2	5 inches	59 inches	extremely channery loam	Granular materials (35 pct. or less passing No. 200), Stone Fragments, Gravel and Sand.	COARSE-GRAINED SOILS, Sands, Sands with fines, Silty Sand.	Max: 42.34 Min: 4.23	Max: 5.5 Min: 3.6

Soil Map ID: 4

Soil Component Name: Elliber

Soil Surface Texture: very channery loam

Hydrologic Group: Class A - High infiltration rates. Soils are deep, well drained to excessively drained sands and gravels.

Soil Drainage Class: Well drained

Hydric Status: Not hydric

Corrosion Potential - Uncoated Steel: Low

Depth to Bedrock Min: > 0 inches

Depth to Watertable Min: > 0 inches

GEOCHECK® - PHYSICAL SETTING SOURCE SUMMARY

Soil Layer Information							
Layer	Boundary		Soil Texture Class	Classification		Saturated hydraulic conductivity micro m/sec	Soil Reaction (pH)
	Upper	Lower		AASHTO Group	Unified Soil		
1	0 inches	5 inches	very channery loam	Granular materials (35 pct. or less passing No. 200), Stone Fragments, Gravel and Sand.	COARSE-GRAINED SOILS, Sands, Sands with fines, Silty Sand.	Max: 42.34 Min: 4.23	Max: 5.5 Min: 3.6
2	5 inches	59 inches	extremely channery loam	Granular materials (35 pct. or less passing No. 200), Stone Fragments, Gravel and Sand.	COARSE-GRAINED SOILS, Sands, Sands with fines, Silty Sand.	Max: 42.34 Min: 4.23	Max: 5.5 Min: 3.6

Soil Map ID: 5

Soil Component Name: Hazleton

Soil Surface Texture: channery sandy loam

Hydrologic Group: Class B - Moderate infiltration rates. Deep and moderately deep, moderately well and well drained soils with moderately coarse textures.

Soil Drainage Class: Well drained

Hydric Status: Not hydric

Corrosion Potential - Uncoated Steel: Low

Depth to Bedrock Min: > 142 inches

Depth to Watertable Min: > 0 inches

GEOCHECK® - PHYSICAL SETTING SOURCE SUMMARY

Soil Layer Information							
Layer	Boundary		Soil Texture Class	Classification		Saturated hydraulic conductivity micro m/sec	Soil Reaction (pH)
	Upper	Lower		AASHTO Group	Unified Soil		
1	0 inches	1 inches	channery sandy loam	Silt-Clay Materials (more than 35 pct. passing No. 200), Silty Soils.	Not reported	Max: 42.34 Min: 3	Max: Min:
2	1 inches	59 inches	extremely channery loam	Silt-Clay Materials (more than 35 pct. passing No. 200), Silty Soils.	Not reported	Max: 42.34 Min: 3	Max: Min:
3	59 inches	63 inches	unweathered bedrock	Silt-Clay Materials (more than 35 pct. passing No. 200), Silty Soils.	Not reported	Max: 42.34 Min: 3	Max: Min:

LOCAL / REGIONAL WATER AGENCY RECORDS

EDR Local/Regional Water Agency records provide water well information to assist the environmental professional in assessing sources that may impact ground water flow direction, and in forming an opinion about the impact of contaminant migration on nearby drinking water wells.

WELL SEARCH DISTANCE INFORMATION

<u>DATABASE</u>	<u>SEARCH DISTANCE (miles)</u>
Federal USGS	1.000
Federal FRDS PWS	Nearest PWS within 1 mile
State Database	1.000

FEDERAL USGS WELL INFORMATION

<u>MAP ID</u>	<u>WELL ID</u>	<u>LOCATION FROM TP</u>
T67	USGS2239350	1/2 - 1 Mile WSW

FEDERAL FRDS PUBLIC WATER SUPPLY SYSTEM INFORMATION

<u>MAP ID</u>	<u>WELL ID</u>	<u>LOCATION FROM TP</u>

GEOCHECK® - PHYSICAL SETTING SOURCE SUMMARY

FEDERAL FRDS PUBLIC WATER SUPPLY SYSTEM INFORMATION

MAP ID	WELL ID	LOCATION FROM TP
K32	PA4050310	1/2 - 1 Mile SSW

Note: PWS System location is not always the same as well location.

STATE DATABASE WELL INFORMATION

MAP ID	WELL ID	LOCATION FROM TP
A1	SPAW0008536	1/8 - 1/4 Mile ENE
A2	PA1000000036805	1/8 - 1/4 Mile ENE
B3	PA1000000036864	1/4 - 1/2 Mile East
B4	SPAW0008615	1/4 - 1/2 Mile East
C5	PA1000000036326	1/4 - 1/2 Mile SE
C6	SPAW0008618	1/4 - 1/2 Mile SE
B7	PA1000000036939	1/4 - 1/2 Mile ENE
D8	PA1000000036076	1/4 - 1/2 Mile SSE
D9	SPAW0008612	1/4 - 1/2 Mile SSE
E10	PA1000000037205	1/2 - 1 Mile ENE
E11	SPAW0008538	1/2 - 1 Mile ENE
E12	PA1000000037236	1/2 - 1 Mile ENE
F13	PA1000000037063	1/2 - 1 Mile ENE
F14	SPAW0008791	1/2 - 1 Mile ENE
E15	SPAW0008776	1/2 - 1 Mile ENE
G16	PA1000000036638	1/2 - 1 Mile East
G17	SPAW0008531	1/2 - 1 Mile East
H18	PA1000000037237	1/2 - 1 Mile ENE
H19	SPAW0008608	1/2 - 1 Mile ENE
I20	PA1000000037428	1/2 - 1 Mile ENE
I21	SPAW0008542	1/2 - 1 Mile ENE
J22	SPAW0008535	1/2 - 1 Mile ESE
J23	PA1000000036456	1/2 - 1 Mile ESE
K24	SPAW0007819	1/2 - 1 Mile SSW
K25	PA1000000035560	1/2 - 1 Mile SSW
L26	SPAW0008525	1/2 - 1 Mile East
L27	PA1000000036995	1/2 - 1 Mile East
M28	PA1000000036806	1/2 - 1 Mile East
M29	SPAW0008749	1/2 - 1 Mile East
L30	SPAW0008524	1/2 - 1 Mile ENE
L31	PA1000000037109	1/2 - 1 Mile ENE
J33	PA1000000036451	1/2 - 1 Mile ESE
K34	PA1000000035540	1/2 - 1 Mile SSW
N35	SPAW0008808	1/2 - 1 Mile ESE
N36	SPAW0008793	1/2 - 1 Mile ESE
N37	PA1000000036360	1/2 - 1 Mile ESE
N38	PA1000000036359	1/2 - 1 Mile ESE
N39	SPAW0008540	1/2 - 1 Mile East
N40	PA1000000036457	1/2 - 1 Mile East
N41	SPAW0008814	1/2 - 1 Mile ESE
N42	PA1000000036387	1/2 - 1 Mile ESE
N43	SPAW0008611	1/2 - 1 Mile ESE
N44	PA1000000036297	1/2 - 1 Mile ESE

GEOCHECK® - PHYSICAL SETTING SOURCE SUMMARY

STATE DATABASE WELL INFORMATION

MAP ID	WELL ID	LOCATION FROM TP
O45	SPAW0008516	1/2 - 1 Mile SE
O46	PA1000000035903	1/2 - 1 Mile SE
P47	SPAW0008752	1/2 - 1 Mile ENE
P48	PA1000000037279	1/2 - 1 Mile ENE
N49	SPAW0008537	1/2 - 1 Mile ESE
N50	PA1000000036298	1/2 - 1 Mile ESE
Q51	SPAW0008815	1/2 - 1 Mile ESE
Q52	PA1000000036239	1/2 - 1 Mile ESE
R53	PA1000000036570	1/2 - 1 Mile East
R54	SPAW0008811	1/2 - 1 Mile East
Q55	PA1000000036327	1/2 - 1 Mile ESE
Q56	SPAW0008813	1/2 - 1 Mile ESE
Q57	PA1000000036268	1/2 - 1 Mile ESE
Q58	SPAW0008810	1/2 - 1 Mile ESE
Q59	PA1000000036240	1/2 - 1 Mile ESE
Q60	SPAW0008807	1/2 - 1 Mile ESE
S61	PA1000000036386	1/2 - 1 Mile WSW
S62	SPAW0008770	1/2 - 1 Mile WSW
S63	SPAW0008604	1/2 - 1 Mile West
S64	PA1000000036412	1/2 - 1 Mile West
65	PA1000000036541	1/2 - 1 Mile East
T66	PA1000000035977	1/2 - 1 Mile WSW
T68	PA1000000036075	1/2 - 1 Mile WSW
T69	SPAW0008767	1/2 - 1 Mile WSW
U70	PA1000000037688	1/2 - 1 Mile ENE
U71	SPAW0008756	1/2 - 1 Mile ENE

PHYSICAL SETTING SOURCE MAP - 2420965.2s

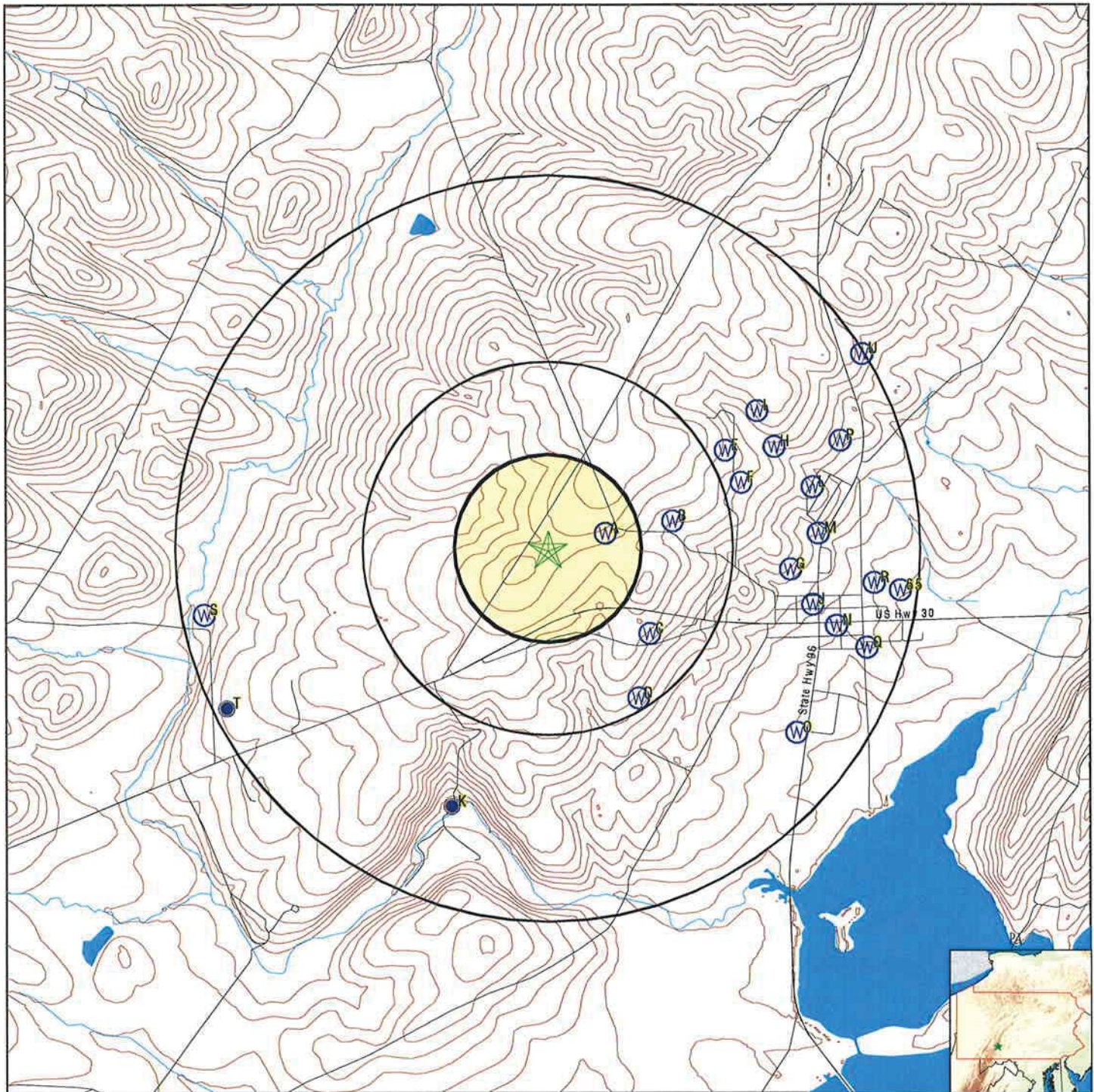

- N County Boundary
- / Major Roads
- / Contour Lines
- ⊙ Earthquake epicenter, Richter 5 or greater
- W Water Wells
- P Public Water Supply Wells
- Cluster of Multiple Icons

- ↑ Groundwater Flow Direction
- GI Indeterminate Groundwater Flow at Location
- GV Groundwater Flow Varies at Location

0 1/4 1/2 1 Miles

SITE NAME: Schellsburg Liberty Towers Site
 ADDRESS: 200 West Ridge Road
 Schellsburg PA 15559
 LAT/LONG: 40.0517 / 78.6582

CLIENT: Burgess Niple, Inc.
 CONTACT: Anna Dougherty
 INQUIRY #: 2420965.2s
 DATE: February 13, 2009 11:35 am

GEOCHECK® - PHYSICAL SETTING SOURCE MAP FINDINGS

Map ID
Direction
Distance
Elevation

Database EDR ID Number

A1
ENE
1/8 - 1/4 Mile
Higher

PA WELLS SPAW0008536

Well ID:	1978N	County	BEDFORD
Owner's Name:	FRAZIER N	Longitude:	783920
Latitude:	400308	Lat/Long Accuracy:	ACCURATE TO +1 MINUTE
Quadrangle:	SCHELLSBURG	Topographic Setting:	HILLSIDE
Hydrologic Unit:	02050303	Site Usage:	WITHDRAWAL
Water Usage:	DOMESTIC	Finish:	OPEN HOLE
Well Depth:	102	Casing1 Diameter(inches):	6
Casing 1:	20	Casing2 Diameter(inches):	Not Reported
Casing2:	Not Reported	Date Drilled:	11-82
Grouted:	Not Reported	Production WL:	Not Reported
Static Water Level:	Not Reported	Yield Measurement Method:	V
Yield (gpm):	4	Test Time:	Not Reported
Drawdown:	Not Reported	Driller:	1608
Bedrock:	10	Water Bearing Zone 2:	70
Water Bearing Zone 1:	45	Lithology:	SHALE
Water Bearing Zone 3:	Not Reported	Remark:	Not Reported
Municipality:	NAPIER		
Aquifer:	NEW SCOTLAND LIMESTONE		

A2
ENE
1/8 - 1/4 Mile
Higher

PA WELLS PA1000000036805

WELLID:	Not Reported	LOCALWELLN:	1978N
COUNTY:	BEDFORD		
AAPG:	347NSCD		
TOPOGRAPHY:	HILLSIDE		
WELLDEPTH:	102		
ELEVATION:	0		
ELEVMETHOD:	Not Reported		
ACCURACYOF:	Not Reported		
HYDROLOGIC:	02050303		
LATLONGACCURACY:	ACCURATE TO +1 MINUTE		
QUAD:	SCHELLSBURG		
TYPEOFSITE:	WELL		
DATECREATE:	Not Reported	DATEUPDATE:	Not Reported
DATAARELIABILITY:	LOCATION MAY NOT BE ACCURATE (WWI paper)		
SOURCE DEPTH DATA:	DRILLER'S RECORD		
MUNICIPALITY:	NAPIER TWP.		
LATITUDEDD:	40.05222		
LONGITUDEDD:	-78.65556		
DEPTHTOBED:	10		
DATEDRILLE:	Not Reported		
PAGWIS ID:	53120		

GEOCHECK® - PHYSICAL SETTING SOURCE MAP FINDINGS

Construction Information:

Construction Date: 11/01/1982 00:00:00
Driller: 1608
Source Cons Data: DRILLER'S RECORD
Method Cons: Not Reported
Finish: OPEN HOLE

Casing Information:

Top Of Casing:	0	Casing Wall Thickness:	Not Reported
Bottom Of Casing:	20	Casing Diameter:	6
Casing:	Not Reported		

Geohydrologic Information:

A A P G:	347NSCD		
Lithology:	SH		
Contributing Unit:	PRIMARY		
Top Of Interval:	Not Reported	Bottom Of Interval:	Not Reported

Water Use Information:

Site Use: WITHDRAWAL
Water Use: DOMESTIC

Owner Information:

Owner: FRAZIER N
Date Ownership: Not Reported

B3
East
1/4 - 1/2 Mile
Lower

PA WELLS PA1000000036864

WELLID:	Not Reported	LOCALWELLN:	2980N
COUNTY:	BEDFORD		
AAPG:	344ODOP		
TOPOGRAPHY:	VALLEY FLAT		
WELLDEPTH:	549		
ELEVATION:	0		
ELEVMETHOD:	Not Reported		
ACCURACYOF:	Not Reported		
HYDROLOGIC:	02050303		
LATLONGACCURACY:	ACCURATE TO +1 MINUTE		
QUAD:	SHELLSBURG		
TYPEOFSITE:	WELL		
DATECREATE:	Not Reported	DATEUPDATE:	Not Reported
DATA RELIABILITY:	LOCATION MAY NOT BE ACCURATE (WWI paper)		
SOURCE DEPTH DATA:	DRILLER'S RECORD		
MUNICIPALITY:	NAPIER TWP.		
LATITUDEDD:	40.0525		
LONGITUDEDD:	-78.6525		
DEPTH TO BED:	44		
DATEDRILLE:	Not Reported		
PAGWIS ID:	53199		

GEOCHECK® - PHYSICAL SETTING SOURCE MAP FINDINGS

Construction Information:

Construction Date: 01/04/1987 00:00:00
Driller: 138
Source Cons Data: DRILLER'S RECORD
Method Cons: Not Reported
Finish: OPEN HOLE

Casing Information:

Top Of Casing:	0	Casing Wall Thickness:	Not Reported
Bottom Of Casing:	50	Casing Diameter:	Not Reported
Casing:	Not Reported		

Geohydrologic Information:

A A P G:	344ODOP		
Lithology:	LS		
Contributing Unit:	PRIMARY		
Top Of Interval:	Not Reported	Bottom Of Interval:	Not Reported

Water Use Information:

Site Use: WITHDRAWAL
Water Use: STOCK

Owner Information:

Owner: EMERICK RICHARD J
Date Ownership: Not Reported

B4
East
1/4 - 1/2 Mile
Lower

PA WELLS SPAW0008615

Well ID:	2980N	County	BEDFORD
Owner's Name:	EMERICK RICHARD J	Longitude:	783909
Latitude:	400309	Lat/Long Accuracy:	ACCURATE TO +1 MINUTE
Quadrangle:	SCHELLSBURG	Topographic Setting:	VALLEY FLAT
Hydrologic Unit:	02050303	Site Usage:	WITHDRAWAL
Water Usage:	STOCK	Finish:	OPEN HOLE
Well Depth:	549	Casing1 Diameter(inches):	Not Reported
Casing 1:	50	Casing2 Diameter(inches):	Not Reported
Casing2:	Not Reported	Date Drilled:	1-4-87
Grouted:	Not Reported	Production WL:	450
Static Water Level:	150	Yield Measurement Method:	E
Yield (gpm):	3	Test Time:	3
Drawdown:	300	Driller:	138
Bedrock:	44	Water Bearing Zone 2:	221
Water Bearing Zone 1:	180	Lithology:	LIMESTONE
Water Bearing Zone 3:	452	Remark:	Not Reported
Municipality:	NAPIER		
Aquifer:	ONONDAGA & OLD PORT FMS		

C5
SE
1/4 - 1/2 Mile
Lower

PA WELLS PA1000000036326

GEOCHECK® - PHYSICAL SETTING SOURCE MAP FINDINGS

WELLID:	Not Reported	LOCALWELLN:	2983N
COUNTY:	BEDFORD		
AAPG:	344ODOP		
TOPOGRAPHY:	HILLSIDE		
WELLDEPTH:	221		
ELEVATION:	0		
ELEVMETHOD:	Not Reported		
ACCURACYOF:	Not Reported		
HYDROLOGIC:	02050303		
LATLONGACCURACY:	ACCURATE TO +1 MINUTE		
QUAD:	SCHELLSBURG		
TYPEOFSITE:	WELL		
DATECREATE:	Not Reported	DATEUPDATE:	Not Reported
DATARELIABILITY:	LOCATION MAY NOT BE ACCURATE (WWI paper)		
SOURCE DEPTH DATA:	DRILLER'S RECORD		
MUNICIPALITY:	NAPIER TWP.		
LATITUDEDD:	40.04833		
LONGITUDEDD:	-78.65333		
DEPTHTOBED:	61		
DATEDRILLE:	Not Reported		
PAGWIS ID:	53202		

Construction Information:

Construction Date:	08/09/1988 00:00:00
Driller:	138
Source Cons Data:	DRILLER'S RECORD
Method Cons:	Not Reported
Finish:	PERFORATED OR SLOTTED

Casing Information:

Top Of Casing:	0	Casing Wall Thickness:	Not Reported
Bottom Of Casing:	65	Casing Diameter:	Not Reported
Casing:	Not Reported		

Geohydrologic Information:

A A P G:	344ODOP		
Lithology:	LS		
Contributing Unit:	PRIMARY		
Top Of Interval:	Not Reported	Bottom Of Interval:	Not Reported

Water Use Information:

Site Use:	WITHDRAWAL
Water Use:	DOMESTIC

Owner Information:

Owner:	MACKIE M B
Date Ownership:	Not Reported

C6
SE
1/4 - 1/2 Mile
Lower

PA WELLS SPAW0008618

GEOCHECK® - PHYSICAL SETTING SOURCE MAP FINDINGS

Well ID:	2983N	County	BEDFORD
Owner's Name:	MACKIE M B	Longitude:	783912
Latitude:	400254	Lat/Long Accuracy:	ACCURATE TO +1 MINUTE
Quadrangle:	SCHELLSBURG	Topographic Setting:	HILLSIDE
Hydrologic Unit:	02050303	Site Usage:	WITHDRAWAL
Water Usage:	DOMESTIC	Finish:	PERFORATED OR SLOTTED
Well Depth:	221	Casing1 Diameter(inches):	Not Reported
Casing 1:	65	Casing2 Diameter(inches):	Not Reported
Casing2:	Not Reported	Date Drilled:	8-9-88
Grouted:	Not Reported	Production WL:	180
Static Water Level:	130	Yield Measurement Method:	E
Yield (gpm):	4	Test Time:	2
Drawdown:	50	Driller:	138
Bedrock:	61	Water Bearing Zone 2:	198
Water Bearing Zone 1:	146	Lithology:	LIMESTONE
Water Bearing Zone 3:	Not Reported	Remark:	Not Reported
Municipality:	NAPIER		
Aquifer:	ONONDAGA & OLD PORT FMS		

B7
ENE
 1/4 - 1/2 Mile
 Lower

PA WELLS PA1000000036939

WELLID:	Not Reported	LOCALWELLN:	Not Reported
COUNTY:	BEDFORD		
AAPG:	Not Reported		
TOPOGRAPHY:	Not Reported		
WELLDEPTH:	396		
ELEVATION:	0		
ELEVMETHOD:	Not Reported		
ACCURACYOF:	Not Reported		
HYDROLOGIC:	Not Reported		
LATLONGACCURACY:	Not Reported		
QUAD:	0		
TYPEOFSITE:	Not Reported		
DATECREATE:	Not Reported	DATEUPDATE:	Not Reported
DATA RELIABILITY:	Not Reported		
SOURCE DEPTH DATA:	Not Reported		
MUNICIPALITY:	NAPIER TWP.		
LATITUDEDD:	40.05306		
LONGITUDEDD:	-78.65139		
DEPTH TO BED:	155		
DATEDRILLE:	Not Reported		
PAGWIS ID:	0		

Construction Information:

Construction Date:	04/22/1999 00:00:00
Driller:	9996
Source Cons Data:	Not Reported
Method Cons:	Not Reported
Finish:	PERFORATED OR SLOTTED

GEOCHECK® - PHYSICAL SETTING SOURCE MAP FINDINGS

Casing Information:

Top Of Casing:	0	Casing Wall Thickness:	Not Reported
Bottom Of Casing:	163	Casing Diameter:	6
Casing:	STEEL		

Hole Information:

Top Of Hole:	0		
Bottom Of Hole:	396	Hole Diameter:	6

Driller Log Information:

Top Of Interval:	0	Bottom Of Interval:	1
Description:	Soil		
Top Of Interval:	1	Bottom Of Interval:	110
Description:	Clay & Sand		
Top Of Interval:	110	Bottom Of Interval:	155
Description:	Brown Shale/Limestone		
Top Of Interval:	155	Bottom Of Interval:	260
Description:	Limestone		
Top Of Interval:	260	Bottom Of Interval:	266
Description:	Broken Limestone		
Top Of Interval:	266	Bottom Of Interval:	370
Description:	Limestone W/Soft Streaks		
Top Of Interval:	370	Bottom Of Interval:	396
Description:	Limestone		

Water Use Information:

Site Use:	Not Reported
Water Use:	DOMESTIC

Owner Information:

Owner:	Mowry
Date Ownership:	Not Reported

D8
SSE
1/4 - 1/2 Mile
Lower

PA WELLS PA1000000036076

WELLID:	Not Reported	LOCALWELLN:	2976N
COUNTY:	BEDFORD		
AAPG:	344ODOP		
TOPOGRAPHY:	HILLSIDE		
WELLDEPTH:	210		
ELEVATION:	0		
ELEVMETHOD:	Not Reported		
ACCURACYOF:	Not Reported		
HYDROLOGIC:	02050303		

GEOCHECK® - PHYSICAL SETTING SOURCE MAP FINDINGS

LATLONGACCURACY:	ACCURATE TO +1 MINUTE	
QUAD:	SCHELLSBURG	
TYPEOFSITE:	WELL	
DATECREATE:	Not Reported	DATEUPDATE: Not Reported
DATARELIABILITY:	LOCATION MAY NOT BE ACCURATE (WWI paper)	
SOURCE DEPTH DATA:	DRILLER'S RECORD	
MUNICIPALITY:	NAPIER TWP.	
LATITUDEDD:	40.04583	
LONGITUDEDD:	-78.65389	
DEPTHTOBED:	31	
DATEDRILLE:	Not Reported	
PAGWIS ID:	53196	

Construction Information:

Construction Date:	10/01/1986 00:00:00
Driller:	209
Source Cons Data:	DRILLER'S RECORD
Method Cons:	Not Reported
Finish:	OPEN HOLE

Casing Information:

Top Of Casing:	0	Casing Wall Thickness:	Not Reported
Bottom Of Casing:	40	Casing Diameter:	Not Reported
Casing:	Not Reported		

Geohydrologic Information:

A A P G:	344ODOP	
Lithology:	SL	
Contributing Unit:	PRIMARY	
Top Of Interval:	Not Reported	Bottom Of Interval: Not Reported

Water Use Information:

Site Use:	WITHDRAWAL
Water Use:	DOMESTIC

Owner Information:

Owner:	MEESE D
Date Ownership:	Not Reported

D9
SSE
1/4 - 1/2 Mile
Lower

PA WELLS SPAW0008612

Well ID:	2976N	County	BEDFORD
Owner's Name:	MEESE D	Longitude:	783914
Latitude:	400245	Lat/Long Accuracy:	ACCURATE TO +1 MINUTE
Quadrangle:	SCHELLSBURG	Topographic Setting:	HILLSIDE
Hydrologic Unit:	02050303	Site Usage:	WITHDRAWAL
Water Usage:	DOMESTIC	Finish:	OPEN HOLE
Well Depth:	210	Casing1 Diameter(inches):	Not Reported
Casing 1:	40	Casing2 Diameter(inches):	Not Reported
Casing2:	Not Reported		

GEOCHECK® - PHYSICAL SETTING SOURCE MAP FINDINGS

Grouted:	Not Reported	Date Drilled:	10-86
Static Water Level:	70	Production WL:	5
Yield (gpm):	6	Yield Measurement Method:	E
Drawdown:	125	Test Time:	1
Bedrock:	31	Driller:	209
Water Bearing Zone 1:	140	Water Bearing Zone 2:	200
Water Bearing Zone 3:	Not Reported	Lithology:	SLATE
Municipality:	NAPIER	Remark:	Not Reported
Aquifer:	ONONDAGA & OLD PORT FMS		

E10
ENE
1/2 - 1 Mile
Lower

PA WELLS **PA1000000037205**

WELLID:	Not Reported	LOCALWELLN:	1980N
COUNTY:	BEDFORD		
AAPG:	347NSCD		
TOPOGRAPHY:	FLAT SURFACE		
WELLDEPTH:	205		
ELEVATION:	0		
ELEVMETHOD:	Not Reported		
ACCURACYOF:	Not Reported		
HYDROLOGIC:	02050303		
LATLONGACCURACY:	ACCURATE TO +1 MINUTE		
QUAD:	SCHELLSBURG		
TYPEOFSITE:	WELL		
DATECREATE:	Not Reported	DATEUPDATE:	Not Reported
DATARELIABILITY:	LOCATION MAY NOT BE ACCURATE (WWI paper)		
SOURCE DEPTH DATA:	DRILLER'S RECORD		
MUNICIPALITY:	NAPIER TWP.		
LATITUDEDD:	40.05528		
LONGITUDEDD:	-78.64944		
DEPTHTOBED:	52		
DATEDRILLE:	Not Reported		
PAGWIS ID:	53122		

Construction Information:

Construction Date:	06/09/1982 00:00:00
Driller:	1058
Source Cons Data:	DRILLER'S RECORD
Method Cons:	Not Reported
Finish:	Not Reported

Casing Information:

Top Of Casing:	0	Casing Wall Thickness:	Not Reported
Bottom Of Casing:	168	Casing Diameter:	Not Reported
Casing:	Not Reported		

Geohydrologic Information:

A A P G:	347NSCD		
Lithology:	LS		
Contributing Unit:	PRIMARY		
Top Of Interval:	Not Reported	Bottom Of Interval:	Not Reported

GEOCHECK® - PHYSICAL SETTING SOURCE MAP FINDINGS

Water Use Information:

Site Use: WITHDRAWAL
Water Use: DOMESTIC

Owner Information:

Owner: BROWN REV
Date Ownership: Not Reported

E11
ENE
1/2 - 1 Mile
Lower

PA WELLS **SPAW0008538**

Well ID:	1980N	County	BEDFORD
Owner's Name:	BROWN REV	Longitude:	783858
Latitude:	400319	Lat/Long Accuracy:	ACCURATE TO +1 MINUTE
Quadrangle:	SCHELLSBURG	Topographic Setting:	FLAT SURFACE
Hydrologic Unit:	02050303	Site Usage:	WITHDRAWAL
Water Usage:	DOMESTIC	Finish:	Not Reported
Well Depth:	205	Casing1 Diameter(inches):	Not Reported
Casing 1:	168	Casing2 Diameter(inches):	Not Reported
Casing2:	Not Reported	Date Drilled:	6-9-82
Grouted:	Not Reported	Production WL:	Not Reported
Static Water Level:	Not Reported	Yield Measurement Method:	V
Yield (gpm):	3	Test Time:	Not Reported
Drawdown:	Not Reported	Driller:	1058
Bedrock:	52	Water Bearing Zone 2:	145
Water Bearing Zone 1:	105	Lithology:	LIMESTONE
Water Bearing Zone 3:	Not Reported	Remark:	Not Reported
Municipality:	NAPIER		
Aquifer:	NEW SCOTLAND LIMESTONE		

E12
ENE
1/2 - 1 Mile
Lower

PA WELLS **PA1000000037236**

WELLID:	Not Reported	LOCALWELLN:	X 1017
COUNTY:	BEDFORD		
AAPG:	347RDGL		
TOPOGRAPHY:	Not Reported		
WELLDEPTH:	160		
ELEVATION:	0		
ELEVMETHOD:	Not Reported		
ACCURACYOF:	Not Reported		
HYDROLOGIC:	Not Reported		
LATLONGACCURACY:	ACCURATE TO +1 MINUTE		
QUAD:	SCHELLSBURG		
TYPEOFSITE:	WELL		
DATECREATE:	Not Reported	DATEUPDATE:	Not Reported
DATA RELIABILITY:	LOCATION MAY NOT BE ACCURATE (WWI paper)		
SOURCE DEPTH DATA:	DRILLER'S RECORD		
MUNICIPALITY:	NAPIER TWP.		
LATITUDEDD:	40.05556		
LONGITUDEDD:	-78.64944		

GEOCHECK® - PHYSICAL SETTING SOURCE MAP FINDINGS

DEPTH TO BED: 135
 DATE DRILLED: Not Reported
 PAGWIS ID: 53360

Construction Information:

Construction Date: 01/01/1969 00:00:00
 Driller: 0443
 Source Cons Data: DRILLER'S RECORD
 Method Cons: Not Reported
 Finish: OPEN HOLE

Casing Information:

Top Of Casing:	0	Casing Wall Thickness:	Not Reported
Bottom Of Casing:	142	Casing Diameter:	6
Casing:	Not Reported		

Geohydrologic Information:

A A P G:	347RDGL		
Lithology:	LS		
Contributing Unit:	PRIMARY		
Top Of Interval:	Not Reported	Bottom Of Interval:	Not Reported

Water Use Information:

Site Use: WITHDRAWAL
 Water Use: DOMESTIC

Owner Information:

Owner: WEAVER WILLIAM
 Date Ownership: Not Reported

F13
ENE
1/2 - 1 Mile
Lower

PA WELLS PA1000000037063

WELLID:	Not Reported	LOCALWELLN:	X 1052
COUNTY:	BEDFORD		
AAPG:	347RDGL		
TOPOGRAPHY:	Not Reported		
WELLDEPTH:	160		
ELEVATION:	0		
ELEVMETHOD:	Not Reported		
ACCURACYOF:	Not Reported		
HYDROLOGIC:	Not Reported		
LATLONGACCURACY:	ACCURATE TO +1 MINUTE		
QUAD:	SHELLSBURG		
TYPEOFSITE:	WELL		
DATECREATE:	Not Reported	DATEUPDATE:	Not Reported
DATARELIABILITY:	LOCATION MAY NOT BE ACCURATE (WWI paper)		
SOURCE DEPTH DATA:	DRILLER'S RECORD		
MUNICIPALITY:	NAPIER TWP.		
LATITUDEDD:	40.05417		
LONGITUDEDD:	-78.64861		

GEOCHECK® - PHYSICAL SETTING SOURCE MAP FINDINGS

DEPTHTO BED: 70
 DATED RILLE: Not Reported
 PAGWIS ID: 53375

Construction Information:

Construction Date: 01/01/1970 00:00:00
 Driller: 0443
 Source Cons Data: DRILLER'S RECORD
 Method Cons: Not Reported
 Finish: OPEN HOLE

Casing Information:

Top Of Casing:	0	Casing Wall Thickness:	Not Reported
Bottom Of Casing:	156	Casing Diameter:	7
Casing:	Not Reported		

Geohydrologic Information:

A A P G:	347RDGL		
Lithology:	SS		
Contributing Unit:	PRIMARY		
Top Of Interval:	Not Reported	Bottom Of Interval:	Not Reported

Water Use Information:

Site Use: WITHDRAWAL
 Water Use: DOMESTIC

Owner Information:

Owner: SMITH DAVID
 Date Ownership: Not Reported

F14
ENE
 1/2 - 1 Mile
 Lower

PA WELLS SPAW0008791

Well ID:	X 1052	County	BEDFORD
Owner's Name:	SMITH DAVID	Longitude:	783855
Latitude:	400315	Lat/Long Accuracy:	ACCURATE TO +1 MINUTE
Quadrangle:	SCHELLSBURG	Topographic Setting:	Not Reported
Hydrologic Unit:	Not Reported	Site Usage:	WITHDRAWAL
Water Usage:	DOMESTIC	Finish:	OPEN HOLE
Well Depth:	160	Casing1 Diameter(inches):	7
Casing 1:	156	Casing2 Diameter(inches):	Not Reported
Casing2:	Not Reported	Date Drilled:	00-00-70
Grouted:	Not Reported	Production WL:	Not Reported
Static Water Level:	120	Yield Measurement Method:	3
Yield (gpm):	2	Test Time:	Not Reported
Drawdown:	Not Reported	Driller:	0443
Bedrock:	70	Water Bearing Zone 2:	Not Reported
Water Bearing Zone 1:	155	Lithology:	SANDSTONE
Water Bearing Zone 3:	Not Reported	Remark:	1816
Municipality:	NAPIER		
Aquifer:	RIDGELEY FORMATION (SANDSTONE)		

GEOCHECK® - PHYSICAL SETTING SOURCE MAP FINDINGS

Map ID
Direction
Distance
Elevation

Database EDR ID Number

E15
ENE
1/2 - 1 Mile
Lower

PA WELLS SPAW0008776

Well ID:	X 1017	County	BEDFORD
Owner's Name:	WEAVER WILLIAM	Longitude:	783858
Latitude:	400320	Lat/Long Accuracy:	ACCURATE TO +1 MINUTE
Quadrangle:	SCHELLSBURG	Topographic Setting:	Not Reported
Hydrologic Unit:	Not Reported	Site Usage:	WITHDRAWAL
Water Usage:	DOMESTIC	Finish:	OPEN HOLE
Well Depth:	160	Casing1 Diameter(inches):	6
Casing 1:	142	Casing2 Diameter(inches):	Not Reported
Casing2:	Not Reported	Date Drilled:	00-00-69
Grouted:	Not Reported	Production WL:	Not Reported
Static Water Level:	130	Yield Measurement Method:	3
Yield (gpm):	2	Test Time:	2
Drawdown:	Not Reported	Driller:	0443
Bedrock:	135	Water Bearing Zone 2:	Not Reported
Water Bearing Zone 1:	149	Lithology:	LIMESTONE
Water Bearing Zone 3:	Not Reported	Remark:	1816
Municipality:	NAPIER		
Aquifer:	RIDGELEY FORMATION (SANDSTONE)		

G16
East
1/2 - 1 Mile
Lower

PA WELLS PA1000000036638

WELLID:	Not Reported	LOCALWELLN:	1973N
COUNTY:	BEDFORD		
AAPG:	347NSCD		
TOPOGRAPHY:	HILLSIDE		
WELLDEPTH:	130		
ELEVATION:	0		
ELEVMETHOD:	Not Reported		
ACCURACYOF:	Not Reported		
HYDROLOGIC:	02050303		
LATLONGACCURACY:	ACCURATE TO +1 MINUTE		
QUAD:	SCHELLSBURG		
TYPEOFSITE:	WELL		
DATECREATE:	Not Reported	DATEUPDATE:	Not Reported
DATARELIABILITY:	LOCATION MAY NOT BE ACCURATE (WWI paper)		
SOURCE DEPTH DATA:	DRILLER'S RECORD		
MUNICIPALITY:	NAPIER TWP.		
LATITUDEDD:	40.05083		
LONGITUDEDD:	-78.64611		
DEPTHTOBED:	4		
DATEDRILLE:	Not Reported		
PAGWIS ID:	53115		

GEOCHECK® - PHYSICAL SETTING SOURCE MAP FINDINGS

Construction Information:

Construction Date: 04/19/1982 00:00:00
Driller: 1058
Source Cons Data: DRILLER'S RECORD
Method Cons: Not Reported
Finish: Not Reported

Casing Information:

Top Of Casing:	0	Casing Wall Thickness:	Not Reported
Bottom Of Casing:	126	Casing Diameter:	Not Reported
Casing:	Not Reported		

Geohydrologic Information:

A A P G:	347NSCD		
Lithology:	CL		
Contributing Unit:	PRIMARY		
Top Of Interval:	Not Reported	Bottom Of Interval:	Not Reported

Water Use Information:

Site Use: WITHDRAWAL
Water Use: DOMESTIC

Owner Information:

Owner: HENDERSON T
Date Ownership: Not Reported

G17
East
1/2 - 1 Mile
Lower

PA WELLS SPAW0008531

Well ID:	1973N	County:	BEDFORD
Owner's Name:	HENDERSON T	Longitude:	783846
Latitude:	400303	Lat/Long Accuracy:	ACCURATE TO +1 MINUTE
Quadrangle:	SCHELLSBURG	Topographic Setting:	HILLSIDE
Hydrologic Unit:	02050303	Site Usage:	WITHDRAWAL
Water Usage:	DOMESTIC	Finish:	Not Reported
Well Depth:	130	Casing1 Diameter(inches):	Not Reported
Casing 1:	126	Casing2 Diameter(inches):	Not Reported
Casing2:	Not Reported	Date Drilled:	4-19-82
Grouted:	Not Reported	Production WL:	Not Reported
Static Water Level:	90	Yield Measurement Method:	V
Yield (gpm):	30	Test Time:	Not Reported
Drawdown:	Not Reported	Driller:	1058
Bedrock:	4	Water Bearing Zone 2:	115
Water Bearing Zone 1:	90	Lithology:	CLAY
Water Bearing Zone 3:	Not Reported	Remark:	Not Reported
Municipality:	NAPIER		
Aquifer:	NEW SCOTLAND LIMESTONE		

H18
ENE
1/2 - 1 Mile
Lower

PA WELLS PA1000000037237

GEOCHECK® - PHYSICAL SETTING SOURCE MAP FINDINGS

WELLID:	Not Reported	LOCALWELLN:	2971N
COUNTY:	BEDFORD		
AAPG:	344ODOP		
TOPOGRAPHY:	HILLSIDE		
WELLDEPTH:	125		
ELEVATION:	0		
ELEVMETHOD:	Not Reported		
ACCURACYOF:	Not Reported		
HYDROLOGIC:	02050303		
LATLONGACCURACY:	ACCURATE TO +1 MINUTE		
QUAD:	SCHELLSBURG		
TYPEOFSITE:	WELL		
DATECREATE:	Not Reported	DATEUPDATE:	Not Reported
DATARELIABILITY:	LOCATION MAY NOT BE ACCURATE (WWI paper)		
SOURCE DEPTH DATA:	DRILLER'S RECORD		
MUNICIPALITY:	NAPIER TWP.		
LATITUDEDD:	40.05556		
LONGITUDEDD:	-78.64694		
DEPTHTOBED:	45		
DATEDRILLE:	Not Reported		
PAGWIS ID:	53192		

Construction Information:

Construction Date:	08/11/1983 00:00:00
Driller:	1058
Source Cons Data:	DRILLER'S RECORD
Method Cons:	Not Reported
Finish:	Not Reported

Casing Information:

Top Of Casing:	0	Casing Wall Thickness:	Not Reported
Bottom Of Casing:	110	Casing Diameter:	Not Reported
Casing:	Not Reported		

Geohydrologic Information:

A A P G:	344ODOP		
Lithology:	O		
Contributing Unit:	PRIMARY		
Top Of Interval:	Not Reported	Bottom Of Interval:	Not Reported

Water Use Information:

Site Use:	WITHDRAWAL
Water Use:	DOMESTIC

Owner Information:

Owner:	FLECK D
Date Ownership:	Not Reported

Remarks Information:

Remark:	ROCK TYPE=FLINTSTONE
Remark Date:	Not Reported

H19
ENE
1/2 - 1 Mile
Lower

PA WELLS SPAW0008608

GEOCHECK® - PHYSICAL SETTING SOURCE MAP FINDINGS

Well ID:	2971N	County	BEDFORD
Owner's Name:	FLECK D	Longitude:	783849
Latitude:	400320	Lat/Long Accuracy:	ACCURATE TO +1 MINUTE
Quadrangle:	SHELLSBURG	Topographic Setting:	HILLSIDE
Hydrologic Unit:	02050303	Site Usage:	WITHDRAWAL
Water Usage:	DOMESTIC	Finish:	Not Reported
Well Depth:	125	Casing1 Diameter(inches):	Not Reported
Casing 1:	110	Casing2 Diameter(inches):	Not Reported
Casing2:	Not Reported	Date Drilled:	8-11-83
Grouted:	Not Reported	Production WL:	Not Reported
Static Water Level:	Not Reported	Yield Measurement Method:	V
Yield (gpm):	15	Test Time:	Not Reported
Drawdown:	Not Reported	Driller:	1058
Bedrock:	45	Water Bearing Zone 2:	120
Water Bearing Zone 1:	100	Lithology:	OTHER
Water Bearing Zone 3:	Not Reported	Remark:	ROCK TYPE=FLINTSTONE
Municipality:	NAPIER		
Aquifer:	ONONDAGA & OLD PORT FMS		

**I20
ENE
1/2 - 1 Mile
Lower**

PA WELLS PA1000000037428

WELLID:	Not Reported	LOCALWELLN:	1984N
COUNTY:	BEDFORD		
AAPG:	347NSCD		
TOPOGRAPHY:	HILLSIDE		
WELLDEPTH:	197		
ELEVATION:	0		
ELEVMETHOD:	Not Reported		
ACCURACYOF:	Not Reported		
HYDROLOGIC:	02050303		
LATLONGACCURACY:	ACCURATE TO +1 MINUTE		
QUAD:	SHELLSBURG		
TYPEOFSITE:	WELL		
DATECREATE:	Not Reported	DATEUPDATE:	Not Reported
DATARELIABILITY:	LOCATION MAY NOT BE ACCURATE (WWI paper)		
SOURCE DEPTH DATA:	DRILLER'S RECORD		
MUNICIPALITY:	NAPIER TWP.		
LATITUDEDD:	40.05694		
LONGITUDEDD:	-78.64778		
DEPTHTOBED:	140		
DATEDRILLE:	Not Reported		
PAGWIS ID:	53126		

Construction Information:

Construction Date:	05/01/1983 00:00:00
Driller:	1608
Source Cons Data:	DRILLER'S RECORD
Method Cons:	Not Reported
Finish:	OPEN HOLE

GEOCHECK® - PHYSICAL SETTING SOURCE MAP FINDINGS

Casing Information:

Top Of Casing:	0	Casing Wall Thickness:	Not Reported
Bottom Of Casing:	153	Casing Diameter:	6
Casing:	Not Reported		

Geohydrologic Information:

A A P G:	347NSCD		
Lithology:	SH		
Contributing Unit:	PRIMARY		
Top Of Interval:	Not Reported	Bottom Of Interval:	Not Reported

Water Use Information:

Site Use:	WITHDRAWAL
Water Use:	DOMESTIC

Owner Information:

Owner:	JENNE W
Date Ownership:	Not Reported

I21
ENE
1/2 - 1 Mile
Lower

PA WELLS **SPAW0008542**

Well ID:	1984N	County	BEDFORD
Owner's Name:	JENNE W	Longitude:	783852
Latitude:	400325	Lat/Long Accuracy:	ACCURATE TO +1 MINUTE
Quadrangle:	SCHELLSBURG	Topographic Setting:	HILLSIDE
Hydrologic Unit:	02050303	Site Usage:	WITHDRAWAL
Water Usage:	DOMESTIC	Finish:	OPEN HOLE
Well Depth:	197	Casing1 Diameter(inches):	6
Casing 1:	153	Casing2 Diameter(inches):	Not Reported
Casing2:	Not Reported	Date Drilled:	5-83
Grouted:	Not Reported	Production WL:	Not Reported
Static Water Level:	50	Yield Measurement Method:	V
Yield (gpm):	15	Test Time:	Not Reported
Drawdown:	Not Reported	Driller:	1608
Bedrock:	140	Water Bearing Zone 2:	185
Water Bearing Zone 1:	180	Lithology:	SHALE
Water Bearing Zone 3:	Not Reported	Remark:	Not Reported
Municipality:	NAPIER		
Aquifer:	NEW SCOTLAND LIMESTONE		

J22
ESE
1/2 - 1 Mile
Lower

PA WELLS **SPAW0008535**

Well ID:	1977N	County	BEDFORD
Owner's Name:	SLACK D	Longitude:	783843
Latitude:	400258	Lat/Long Accuracy:	ACCURATE TO +1 MINUTE
Quadrangle:	SCHELLSBURG	Topographic Setting:	FLAT SURFACE
Hydrologic Unit:	02050303	Site Usage:	WITHDRAWAL
Water Usage:	DOMESTIC	Finish:	Not Reported
Well Depth:	225	Casing1 Diameter(inches):	Not Reported
Casing 1:	21	Casing2 Diameter(inches):	Not Reported
Casing2:	Not Reported		

GEOCHECK® - PHYSICAL SETTING SOURCE MAP FINDINGS

Grouted:	Not Reported	Date Drilled:	10-15-81
Static Water Level:	62	Production WL:	Not Reported
Yield (gpm):	4	Yield Measurement Method:	V
Drawdown:	Not Reported	Test Time:	Not Reported
Bedrock:	10	Driller:	1058
Water Bearing Zone 1:	172	Water Bearing Zone 2:	Not Reported
Water Bearing Zone 3:	Not Reported	Lithology:	LIMESTONE
Municipality:	NAPIER	Remark:	Not Reported
Aquifer:	NEW SCOTLAND LIMESTONE		

J23
ESE
1/2 - 1 Mile
Lower

PA WELLS PA1000000036456

WELLID:	Not Reported	LOCALWELLN:	1977N
COUNTY:	BEDFORD		
AAPG:	347NSCD		
TOPOGRAPHY:	FLAT SURFACE		
WELLDEPTH:	225		
ELEVATION:	0		
ELEVMETHOD:	Not Reported		
ACCURACYOF:	Not Reported		
HYDROLOGIC:	02050303		
LATLONGACCURACY:	ACCURATE TO +1 MINUTE		
QUAD:	SCHELLSBURG		
TYPEOFSITE:	WELL		
DATECREATE:	Not Reported	DATEUPDATE:	Not Reported
DATARELIABILITY:	LOCATION MAY NOT BE ACCURATE (WWI paper)		
SOURCE DEPTH DATA:	DRILLER'S RECORD		
MUNICIPALITY:	NAPIER TWP.		
LATITUDEDD:	40.04944		
LONGITUDEDD:	-78.64528		
DEPTHTOBED:	10		
DATEDRILLE:	Not Reported		
PAGWIS ID:	53119		

Construction Information:

Construction Date:	10/15/1981 00:00:00
Driller:	1058
Source Cons Data:	DRILLER'S RECORD
Method Cons:	Not Reported
Finish:	Not Reported

Casing Information:

Top Of Casing:	0	Casing Wall Thickness:	Not Reported
Bottom Of Casing:	21	Casing Diameter:	Not Reported
Casing:	Not Reported		

Geohydrologic Information:

A A P G:	347NSCD		
Lithology:	LS		
Contributing Unit:	PRIMARY		
Top Of Interval:	Not Reported	Bottom Of Interval:	Not Reported

GEOCHECK® - PHYSICAL SETTING SOURCE MAP FINDINGS

Water Use Information:

Site Use: WITHDRAWAL
Water Use: DOMESTIC

Owner Information:

Owner: SLACK D
Date Ownership: Not Reported

K24
SSW
1/2 - 1 Mile
Lower

PA WELLS SPAW0007819

Well ID:	2696N	County	BEDFORD
Owner's Name:	BOYER D	Longitude:	783946
Latitude:	400230	Lat/Long Accuracy:	ACCURATE TO +1 MINUTE
Quadrangle:	SCHELLSBURG	Topographic Setting:	VALLEY FLAT
Hydrologic Unit:	02050303	Site Usage:	WITHDRAWAL
Water Usage:	DOMESTIC	Finish:	PERFORATED OR SLOTTED
Well Depth:	200	Casing1 Diameter(inches):	Not Reported
Casing 1:	89	Casing2 Diameter(inches):	Not Reported
Casing2:	Not Reported	Date Drilled:	2-15-89
Grouted:	Not Reported	Production WL:	71
Static Water Level:	53	Yield Measurement Method:	V
Yield (gpm):	28	Test Time:	24
Drawdown:	18	Driller:	1090
Bedrock:	79	Water Bearing Zone 2:	Not Reported
Water Bearing Zone 1:	115	Lithology:	SHALE
Water Bearing Zone 3:	Not Reported	Remark:	Not Reported
Municipality:	JUNIATA		
Aquifer:	ONONDAGA & OLD PORT FMS		

K25
SSW
1/2 - 1 Mile
Lower

PA WELLS PA1000000035560

WELLID:	Not Reported	LOCALWELLN:	2696N
COUNTY:	BEDFORD		
AAPG:	3440DOP		
TOPOGRAPHY:	VALLEY FLAT		
WELLDEPTH:	200		
ELEVATION:	0		
ELEVMETHOD:	Not Reported		
ACCURACYOF:	Not Reported		
HYDROLOGIC:	02050303		
LATLONGACCURACY:	ACCURATE TO +1 MINUTE		
QUAD:	SCHELLSBURG		
TYPEOFSITE:	WELL		
DATECREATE:	Not Reported	DATEUPDATE:	Not Reported
DATARELIABILITY:	LOCATION MAY NOT BE ACCURATE (WWI paper)		
SOURCE DEPTH DATA:	DRILLER'S RECORD		
MUNICIPALITY:	JUNIATA TWP.		
LATITUDEDD:	40.04167		
LONGITUDEDD:	-78.66278		

GEOCHECK® - PHYSICAL SETTING SOURCE MAP FINDINGS

DEPTHTO BED: 79
DATEDRILLE: Not Reported
PAGWIS ID: 52403

Construction Information:

Construction Date: 02/15/1989 00:00:00
Driller: 1090
Source Cons Data: DRILLER'S RECORD
Method Cons: Not Reported
Finish: PERFORATED OR SLOTTED

Casing Information:

Top Of Casing:	0	Casing Wall Thickness:	Not Reported
Bottom Of Casing:	89	Casing Diameter:	Not Reported
Casing:	Not Reported		

Geohydrologic Information:

A A P G:	3440DOP		
Lithology:	SH		
Contributing Unit:	PRIMARY		
Top Of Interval:	Not Reported	Bottom Of Interval:	Not Reported

Water Use Information:

Site Use: WITHDRAWAL
Water Use: DOMESTIC

Owner Information:

Owner: BOYER D
Date Ownership: Not Reported

L26
East
1/2 - 1 Mile
Lower

PA WELLS SPAW0008525

Well ID:	1967N	County	BEDFORD
Owner's Name:	WILLIAMS R	Longitude:	783842
Latitude:	400313	Lat/Long Accuracy:	ACCURATE TO +1 MINUTE
Quadrangle:	SCHELLSBURG	Topographic Setting:	FLAT SURFACE
Hydrologic Unit:	02050303	Site Usage:	WITHDRAWAL
Water Usage:	DOMESTIC	Finish:	Not Reported
Well Depth:	105	Casing1 Diameter(inches):	Not Reported
Casing 1:	21	Casing2 Diameter(inches):	Not Reported
Casing2:	Not Reported	Date Drilled:	5-22-80
Grouted:	Not Reported	Production WL:	Not Reported
Static Water Level:	60	Yield Measurement Method:	V
Yield (gpm):	20	Test Time:	Not Reported
Drawdown:	Not Reported	Driller:	1058
Bedrock:	10	Water Bearing Zone 2:	Not Reported
Water Bearing Zone 1:	83	Lithology:	LIMESTONE
Water Bearing Zone 3:	Not Reported	Remark:	Not Reported
Municipality:	NAPIER		
Aquifer:	NEW SCOTLAND LIMESTONE		

GEOCHECK® - PHYSICAL SETTING SOURCE MAP FINDINGS

Map ID
Direction
Distance
Elevation

Database EDR ID Number

L27
East
1/2 - 1 Mile
Lower

PA WELLS PA1000000036995

WELLID:	Not Reported	LOCALWELLN:	1967N
COUNTY:	BEDFORD		
AAPG:	347NSCD		
TOPOGRAPHY:	FLAT SURFACE		
WELLDEPTH:	105		
ELEVATION:	0		
ELEVMETHOD:	Not Reported		
ACCURACYOF:	Not Reported		
HYDROLOGIC:	02050303		
LATLONGACCURACY:	ACCURATE TO +1 MINUTE		
QUAD:	SCHELLSBURG		
TYPEOFSITE:	WELL		
DATECREATE:	Not Reported	DATEUPDATE:	Not Reported
DATARELIABILITY:	LOCATION MAY NOT BE ACCURATE (WWI paper)		
SOURCE DEPTH DATA:	DRILLER'S RECORD		
MUNICIPALITY:	NAPIER TWP.		
LATITUDEDD:	40.05361		
LONGITUDEDD:	-78.645		
DEPTHTOBED:	10		
DATEDRILLE:	Not Reported		
PAGWIS ID:	53109		

Construction Information:

Construction Date:	05/22/1980 00:00:00
Driller:	1058
Source Cons Data:	DRILLER'S RECORD
Method Cons:	Not Reported
Finish:	Not Reported

Casing Information:

Top Of Casing:	0	Casing Wall Thickness:	Not Reported
Bottom Of Casing:	21	Casing Diameter:	Not Reported
Casing:	Not Reported		

Geohydrologic Information:

A A P G:	347NSCD		
Lithology:	LS		
Contributing Unit:	PRIMARY		
Top Of Interval:	Not Reported	Bottom Of Interval:	Not Reported

Water Use Information:

Site Use:	WITHDRAWAL
Water Use:	DOMESTIC

Owner Information:

Owner:	WILLIAMS R
Date Ownership:	Not Reported

GEOCHECK® - PHYSICAL SETTING SOURCE MAP FINDINGS

Map ID
Direction
Distance
Elevation

Database EDR ID Number

M28
East
1/2 - 1 Mile
Lower

PA WELLS PA1000000036806

WELLID:	Not Reported	LOCALWELLN:	* X 0408
COUNTY:	BEDFORD		
AAPG:	344ONDG		
TOPOGRAPHY:	Not Reported		
WELLDEPTH:	160		
ELEVATION:	0		
ELEVMETHOD:	Not Reported		
ACCURACYOF:	Not Reported		
HYDROLOGIC:	Not Reported		
LATLONGACCURACY:	ACCURATE TO +1 MINUTE		
QUAD:	SCHELLSBURG		
TYPEOFSITE:	WELL		
DATECREATE:	Not Reported	DATEUPDATE:	Not Reported
DATARELIABILITY:	LOCATION MAY NOT BE ACCURATE (WWI paper)		
SOURCE DEPTH DATA:	DRILLER'S RECORD		
MUNICIPALITY:	NAPIER TWP.		
LATITUDEDD:	40.05222		
LONGITUDEDD:	-78.64472		
DEPTHTOBED:	145		
DATEDRILLE:	Not Reported		
PAGWIS ID:	53333		

Construction Information:

Construction Date:	01/01/1969 00:00:00
Driller:	0443
Source Cons Data:	DRILLER'S RECORD
Method Cons:	Not Reported
Finish:	OPEN HOLE

Casing Information:

Top Of Casing:	0	Casing Wall Thickness:	Not Reported
Bottom Of Casing:	150	Casing Diameter:	6
Casing:	Not Reported		

Geohydrologic Information:

A A P G:	344ONDG		
Lithology:	LS		
Contributing Unit:	PRIMARY		
Top Of Interval:	Not Reported	Bottom Of Interval:	Not Reported

Water Use Information:

Site Use:	WITHDRAWAL
Water Use:	DOMESTIC

Owner Information:

Owner:	MIDDLEMISS D
Date Ownership:	Not Reported

GEOCHECK® - PHYSICAL SETTING SOURCE MAP FINDINGS

Map ID
Direction
Distance
Elevation

Database EDR ID Number

M29
East
1/2 - 1 Mile
Lower

PA WELLS SPAW0008749

Well ID:	X 0408	County	BEDFORD
Owner's Name:	MIDDLEMISS D	Longitude:	783841
Latitude:	400308	Lat/Long Accuracy:	ACCURATE TO +1 MINUTE
Quadrangle:	SCHELLSBURG	Topographic Setting:	Not Reported
Hydrologic Unit:	Not Reported	Site Usage:	WITHDRAWAL
Water Usage:	DOMESTIC	Finish:	OPEN HOLE
Well Depth:	160	Casing1 Diameter(inches):	6
Casing 1:	150	Casing2 Diameter(inches):	Not Reported
Casing2:	Not Reported	Date Drilled:	00-00-69
Grouted:	Not Reported	Production WL:	Not Reported
Static Water Level:	120	Yield Measurement Method:	3
Yield (gpm):	1	Test Time:	2
Drawdown:	Not Reported	Driller:	0443
Bedrock:	145	Water Bearing Zone 2:	Not Reported
Water Bearing Zone 1:	155	Lithology:	LIMESTONE
Water Bearing Zone 3:	Not Reported	Remark:	1816
Municipality:	NAPIER		
Aquifer:	ONONDAGA FORMATION/LIMEST		

L30
ENE
1/2 - 1 Mile
Lower

PA WELLS SPAW0008524

Well ID:	1966N	County	BEDFORD
Owner's Name:	COOLBAUGH J	Longitude:	783842
Latitude:	400316	Lat/Long Accuracy:	ACCURATE TO +1 MINUTE
Quadrangle:	SCHELLSBURG	Topographic Setting:	HILLSIDE
Hydrologic Unit:	02050303	Site Usage:	WITHDRAWAL
Water Usage:	DOMESTIC	Finish:	Not Reported
Well Depth:	105	Casing1 Diameter(inches):	Not Reported
Casing 1:	46	Casing2 Diameter(inches):	Not Reported
Casing2:	Not Reported	Date Drilled:	5-27-80
Grouted:	Not Reported	Production WL:	Not Reported
Static Water Level:	Not Reported	Yield Measurement Method:	V
Yield (gpm):	8	Test Time:	Not Reported
Drawdown:	Not Reported	Driller:	1058
Bedrock:	25	Water Bearing Zone 2:	Not Reported
Water Bearing Zone 1:	95	Lithology:	LIMESTONE
Water Bearing Zone 3:	Not Reported	Remark:	Not Reported
Municipality:	NAPIER		
Aquifer:	NEW SCOTLAND LIMESTONE		

L31
ENE
1/2 - 1 Mile
Lower

PA WELLS PA1000000037109

GEOCHECK® - PHYSICAL SETTING SOURCE MAP FINDINGS

WELLID:	Not Reported	LOCALWELLN:	1966N
COUNTY:	BEDFORD		
AAPG:	347NSCD		
TOPOGRAPHY:	HILLSIDE		
WELLDEPTH:	105		
ELEVATION:	0		
ELEVMETHOD:	Not Reported		
ACCURACYOF:	Not Reported		
HYDROLOGIC:	02050303		
LATLONGACCURACY:	ACCURATE TO +1 MINUTE		
QUAD:	SCHELLSBURG		
TYPEOFSITE:	WELL		
DATECREATE:	Not Reported	DATEUPDATE:	Not Reported
DATA RELIABILITY:	LOCATION MAY NOT BE ACCURATE (WWI paper)		
SOURCE DEPTH DATA:	DRILLER'S RECORD		
MUNICIPALITY:	NAPIER TWP.		
LATITUDEDD:	40.05444		
LONGITUDEDD:	-78.645		
DEPTH TO BED:	25		
DATEDRILLE:	Not Reported		
PAGWIS ID:	53108		

Construction Information:

Construction Date:	05/27/1980 00:00:00
Driller:	1058
Source Cons Data:	DRILLER'S RECORD
Method Cons:	Not Reported
Finish:	Not Reported

Casing Information:

Top Of Casing:	0	Casing Wall Thickness:	Not Reported
Bottom Of Casing:	46	Casing Diameter:	Not Reported
Casing:	Not Reported		

Geohydrologic Information:

A A P G:	347NSCD		
Lithology:	LS		
Contributing Unit:	PRIMARY		
Top Of Interval:	Not Reported	Bottom Of Interval:	Not Reported

Water Use Information:

Site Use:	WITHDRAWAL
Water Use:	DOMESTIC

Owner Information:

Owner:	COOLBAUGH J
Date Ownership:	Not Reported

K32
SSW
1/2 - 1 Mile
Lower

FRDS PWS PA4050310

PWS ID:	PA4050310	PWS Status:	Active
Date Initiated:	Not Reported	Date Deactivated:	Not Reported
PWS Name:	CAMP LIVING WATERS		
	REV LAWRENCE 323 S MAPLE AVE		
	GREENSBURG, PA 15681		